



Northwest Region Office  
711 Independent Ave  
Grand Junction, CO 81505  
cpw.state.co.us

**Project Questions and Answers - 8/5/24**  
Rifle Falls SFU – Isolation Building

1. **Question:** We understand the tanks will be fresh water filled. Please confirm there will be no chemicals in the tanks. Particularly chlorine? This impacts the electrical scope of work.

Answer: That is correct, the tanks will only be filled with fresh water.

2. **Question:** Xcel Energy, will they complete their trench and backfill for underground to the building? Or will the excavator need to include the trench and backfill for the electrical service to the building in their proposal? If yes, how many LF should the excavator include for this item?

Answer: The contractor is to coordinate installing and connecting service to a new pole and meter with Xcel Energy. A service order application was initially submitted by CPW, and can be used for reference (see Addendum No. 1). Xcel's project cost is to be paid by the contractor at the price quoted by Xcel. The quoted price will be reimbursed by CPW, replacing \$5,000 allowance amount for Bid Item 11.

Any costs associated with bringing power from the new meter to the building, along with all costs identified by Xcel to be the Customer's responsibility are to be included in Bid Item 12. This includes any costs for trench and backfill. The location of the meter will be determined during Xcel's design phase, so the exact trench length is to be determined. For bidding purposes assume that the trench length will not exceed 10 feet.

3. **Question:** During the site visit there was discussion of completion next calendar year, not to extend past June 30, 2025. The project solicitation schedule of dates, reflects completion in December 2024. Please confirm if winter sets in, the contractor may structure their schedule for next year (2025) completion?

Answer: The project schedule shown in the bid documents is tentative, and does not account for weather delays. If weather prevents the completion of the project this winter, it may be finished in the spring. The project must be complete by June 30, 2025, the funding expiration date.

4. **Question:** During the site visit, discussion of excavation spoils onsite, no export. Coordinate with facility staff for placement of spoils onsite. Please confirm.

Answer: Export of excess soil will not be required, it will instead be disposed of on site at a location approved by the Project Manager.

5. **Question:** Excavation next to fish runs will require dust control. Please confirm onsite water cannot be used for dust control, and excavator will need to provide their own source of water for construction.

Answer: The hatchery's truck fill station will be available for dust control and other construction needs. The fill station is located on the south end of the raceways.



# COLORADO

Parks and Wildlife

Department of Natural Resources

Northwest Region Office  
711 Independent Ave  
Grand Junction, CO 81505  
cpw.state.co.us

## Project Questions and Answers - 8/5/24 Rifle Falls SFU – Isolation Building

6. Question: Discussion during site visit, if funds are not available for the entire project, some of the bid items may be removed from the scope, and trades need to be mindful how they breakout their proposals. Reference: Bid Schedule items 1-16.

Answer: Base bid items 1-12 will be included in the Contract. Additional bid items 13-16 may or may not be awarded at CPW discretion. Bid item quantities may be adjusted in accordance with the General Conditions for Capital Construction.

7. Question: What is the existing 16" PVC water line type (SCH40, SCH80, C900)?

Answer: The existing water line is 15" SCH 80 PVC (see Addendum No. 1).

8. Question: Is a cold joint allowed where the curb meets the interior slab provided it's tied in with dowels? (see image)

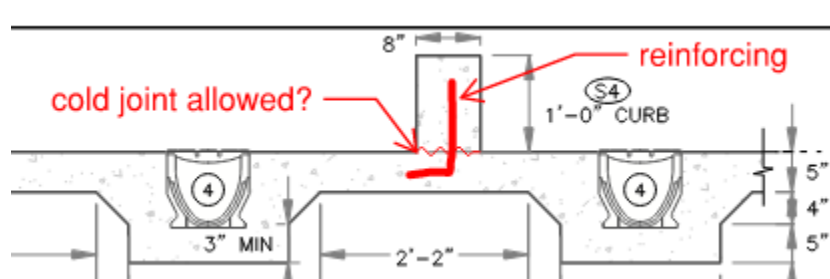

Answer: The construction method shown above will be allowed, and any costs should be included in Bid Item 7 - Concrete Slab. Reinforcement size and spacing is to be approved by the Project Manager.

9. Question: Please clarify the height of the curb mentioned in previous question. Image below calls out an 8" w x 10" high curb but detail B/6-6 shows 1' tall.

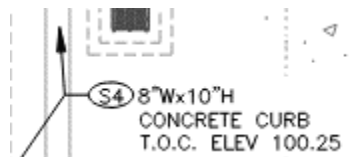

Answer: The callout shown on the referenced image from the foundation plan indicates an incorrect dimension. The interior concrete curb, S4 is to be 8" wide x 12" tall. See Addendum No. 1.

10. Question: Please verify that the only reinforcing in the slabs is 7.5lbs/cy of fiber and no rebar.

Answer: That is correct. See bid documents for reinforcement requirements.



Northwest Region Office  
711 Independent Ave  
Grand Junction, CO 81505  
cpw.state.co.us

**Project Questions and Answers - 8/5/24**  
Rifle Falls SFU – Isolation Building

11. Question: Is the 30"x30"x4" thick non-reinforced encasement shown on sheet 10 of 11 (image below) being performed by plumbing contractor or should I include it in my proposal?

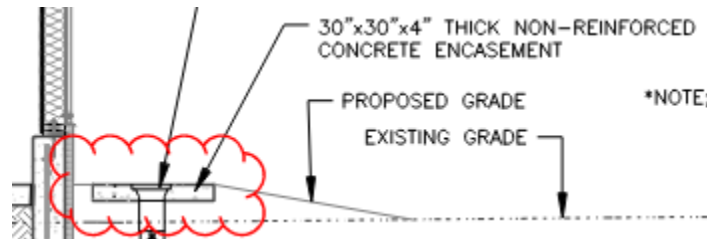

Answer: The cost for the concrete encasement shown in the referenced image should be included Bid Item 7. - Concrete Slab.

12. Question: Are Davis Bacon Wages in effect?

Answer: Davis Bacon Wage rates do not apply for this project.

13. Question: Do you have a preferred vendor for the fiberglass tanks?

Answer: The tanks are to be "RCT-235-S" By Gemini Fiberglass (719)-896-4797 or approved equivalent . See Section 15440 for Fiberglass Tank requirements. Tank color to be approved by Project Manager.

14. Question: Where does the electrical service feed from?

15. Question: What does the electrical service feed from?

16. Question: What does the \$5,000 electrical allowance cover?

Answer (14-16): The contractor is to coordinate installing and connecting service to a new pole and meter with Xcel Energy. A service order application was initially submitted by CPW, and can be used for reference (see Addendum No. 1). Xcel's project cost is to be paid by the contractor at the price quoted by Xcel. The quoted price will be reimbursed by CPW, replacing the \$5,000 allowance amount for Bid Item 11.

Any costs associated with bringing power from the new meter to the building, along with all costs identified by Xcel to be the Customer's responsibility are to be included in Bid Item 12.

17. Question: Can you provide a spec for the 1/2 pvc wall, ceiling, and trim material?

Answer: See SECTION 06600 - PVC WALL AND CEILING PANELING.

18. Question: Interior stairs, would you like those finished with paint? If yes, please clarify what paint product you would like applied.

Answer: The stairs should be stained with Sherwin Williams "SuperDeck" or approved equivalent, see Addendum No. 1.