

Technical Information

All product dimensions are nominal.

Notes

Install this product according to the installation guide.

PRODUCT SPECIFICATIONS

Dayton® Stainless Steel 27" x 22" x 8" Single Bowl Dual Mount Sink. Sink is manufactured from 18 gauge 300 series Stainless Steel with a Elite Satin finish, Center drain placement, and Bottom only pads.

SK-3



Installation Type:	Drop-in, Undermount
Material:	300 series Stainless Steel
Special Features:	Slim Rim
Finish:	Elite Satin
Gauge:	18
Sound Deadening:	Bottom only pads
Number of Bowls:	1
Sink Dimensions:	27" x 22" x 8"
Bowl 1 Dimensions:	24" x 16" x 8"
Drain Size:	3-1/2" (89mm)
Drain Location:	Center
Minimum Cabinet Size:	30"
Mounting Hardware:	Part # 64090012 included for drop-in installation for countertops up to 3/4" (19mm) thick.
Template Included:	No
Cutout Template #:	1000000907

Template is available for download at [elkay.com](#). CAD software will be required to open the template.

Cutout Dimensions for Drop-in Installation:

26-3/8" x 21-3/8" (670mm x 543mm) with 1-1/2" (38mm) corner radius

Hole Drilling Configurations:

1-1/2" (38mm) Diameter Faucet Holes on 4" (102mm) Centers

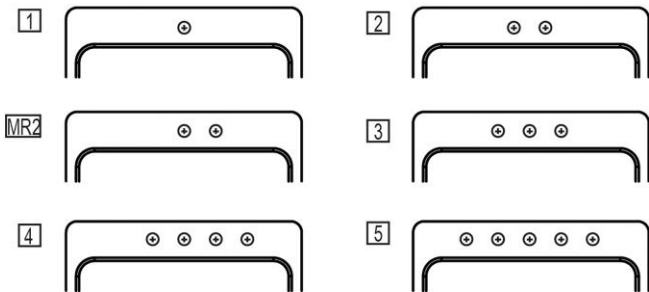

A Century of Tradition and Quality.

For more than 100 years, Elkay has been making innovative products and providing exceptional customer care. We take pride in offering plumbing products that make life easier, inspire change and leave the world a better place.



Product Compliance: ASME A112.19.3/CSA B45.4



Sinks are listed by IAPMO® as meeting the applicable requirements of the Uniform Plumbing Code®, International Plumbing Code®, and National Plumbing Code of Canada.

[Clean and Care Manual \(PDF\)](#)
[Installation Instructions \(PDF\) - 100005237](#)
[Warranty \(PDF\)](#)

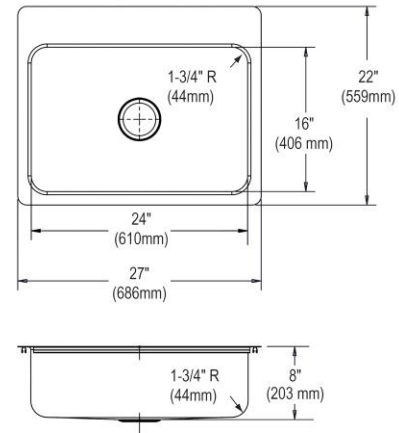

PART: _____ QTY: _____

PROJECT: _____

CONTACT: _____

DATE: _____





NOTES: _____

APPROVAL: _____

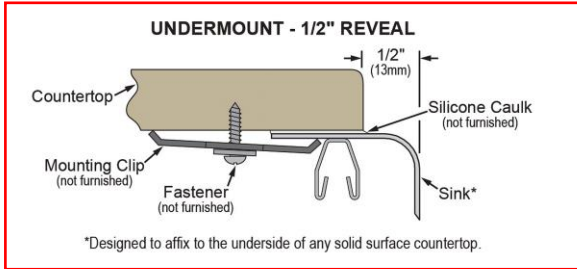
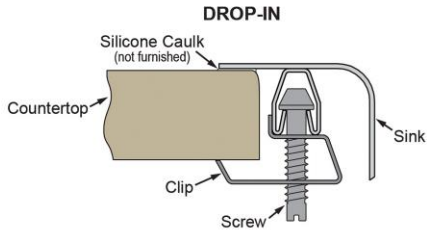
In keeping with our policy of continuing product improvement, Elkay reserves the right to change product specifications without notice. Please visit [elkay.com](#) for the most current version of Elkay product specification sheets. This specification describes an Elkay product with design, quality, and functional benefits to the user. When making a comparison of other producers' offerings, be certain these features are not overlooked.

Installation Profile:



Optional Accessories		
GBG2416SS	Dayton [®] Stainless Steel 22-3/4" x 14-3/4" x 1" Bottom Grid Spec Sheet (PDF)	
CB1713	Elkay Hardwood 13-1/2" x 17" x 1" Cutting Board Spec Sheet (PDF)	
CBS1316	Hardwood 14-1/2" x 17" x 3/4" Cutting Board Spec Sheet (PDF)	
D1125	Dayton [®] 3-1/2" Stainless Steel Drain with Removable Basket Strainer and Rubber Stopper Spec Sheet (PDF)	

In keeping with our policy of continuing product improvement, Elkay reserves the right to change product specifications without notice. Please visit elkay.com for the most current version of Elkay product specification sheets. This specification describes an Elkay product with design, quality, and functional benefits to the user. When making a comparison of other producers' offerings, be certain these features are not overlooked.



6114.301 Shown

MODEL NUMBER:

SK-3

- 6114.301 Single Control Faucet with Remote Valve**
Field-convertible rigid / swivel gooseneck spout. Metal lever handle with red/blue index. 1.5 gpm pressure compensating aerator. With color matched spray.
- 6114.300 Single Control Faucet with Remote Valve**
Field-convertible rigid / swivel gooseneck spout. Metal lever handle with red/blue index. 1.5 gpm pressure compensating aerator. Less spray.

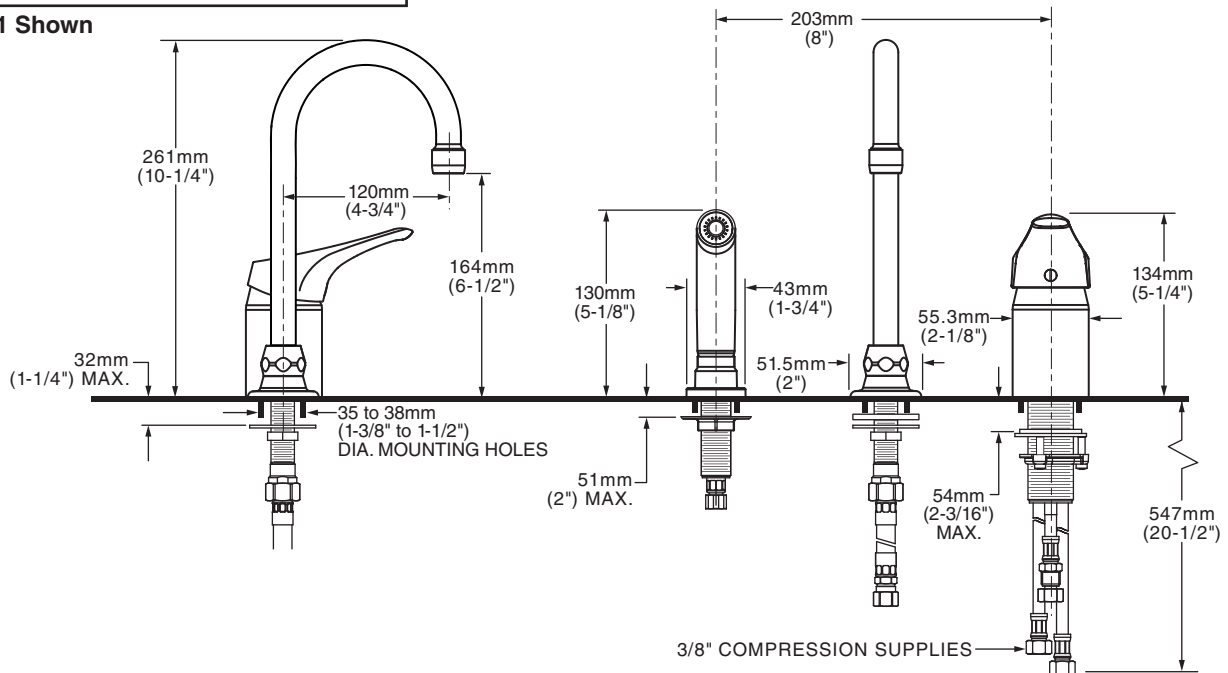

GENERAL DESCRIPTION:

Durable cast brass construction. Field-convertible rigid-swivel gooseneck spout. Ceramic disc valve cartridge with integral hot limit safety stop. 20" long S.S. flex inlet hoses with 3/8" compression fittings. Metal lever handle with red/blue index. 1.5 gpm/5.7L/min. maximum flow rate.

PRODUCT FEATURES:

Pressure Compensating Aerator: Provides a constant water flow of 1.5 gpm throughout the pressure range.

Solid Brass Construction: Durable. Excellent in high use applications. Ideal for prolonged contact with water.

Ceramic Disc Valve Cartridge: Assures a lifetime of drip-free performance.

Adjustable Hot Limit Safety Stop: Limits the amount of hot water allowed to mix with cold. Reduces the risk of accidental scalding.

Field-Convertible Rigid / Swivel Gooseneck Spout

Lead Free: Faucet contains ≤ 0.25% total lead content by weighted average.

SUGGESTED SPECIFICATION:

Single control kitchen fitting shall feature a brass body with metal handle and brass field convertible rigid /swivel gooseneck spout. Shall also feature washerless ceramic disc valve cartridge with integral hot limit safety stop. Fitting shall be American Standard Model #6114.30_.002.



MONTERREY™
SINGLE CONTROL KITCHEN FAUCET
WITH BRASS GOOSENECK SPOUT

CODES AND STANDARDS

These products meet or exceed the following codes and standards:

- ASME A112.18.1**
- CSA B 125**
- NSF 61/Section 9, Annex G**
- CALGreen**

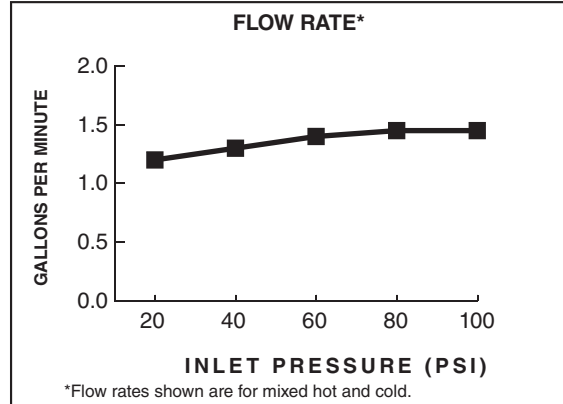

Product Number	Description	Finish
		Polished Chrome
		002
6114.301	Single Control Faucet with Remote Valve. Field-convertible rigid / swivel spout with 5" reach. 1.5 gpm pressure compensating aerator. With color matched spray.	
6114.300	Single Control Faucet with Remote Valve. Field-convertible rigid / swivel spout with 5" reach. 1.5 gpm pressure compensating aerator. Less spray.	

MEETS THE AMERICANS WITH DISABILITIES ACT GUIDELINES AND **ANSI A117.1** REQUIREMENTS FOR ACCESSIBLE AND USABLE BUILDING FACILITIES-CHECK LOCAL CODES

Other Aerators Available:

Part Suffix	Description
LV15	1.5 gpm (5.7 Lpm) Vandal-Resistant PCA Non-Aerated Laminar Flow Outlet
L15	1.5 gpm (5.7 Lpm) PCA Non-Aerated Laminar Flow Outlet
V15	1.5 gpm (5.7 Lpm) Vandal-Resistant PCA Aerator
LV10	1.0 gpm (3.8 Lpm) Vandal-Resistant PCA Non-Aerated Laminar Flow Outlet
L10	1.0 gpm (3.8 Lpm) PCA Non-Aerated Laminar Flow Outlet
V10	1.0 gpm (3.8 Lpm) Vandal-Resistant PCA Aerator
V05	0.5 gpm (1.9 Lpm) Vandal-Resistant PCA Non-Aerated Spray
V035	0.35 gpm (1.3 Lpm) Vandal-Resistant PCA Non-Aerated Spray

*PCA - Pressure Compensating
 All modifications meet CALGreen Code

Features

- Removable basket strainer with open/close stopper
- Tailpiece included
- Quick-locking installation system
- For sink installations with 3-1/2" (89 mm) or 4" (102 mm) outlet

Material

- Solid-brass construction for durability and reliability

Recommended Products/Accessories

- K-23726 Drain treatment
- K-23723 Faucet cleaner

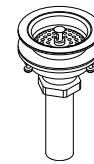
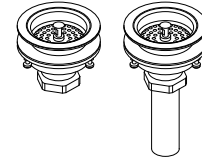

Codes/Standards









ASME A112.18.2/CSA B125.2

**KOHLER® One-Year Limited
Warranty**

See website for detailed warranty information.

Available Colors/Finishes

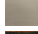
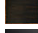
Color tiles intended for reference only.

Color	Code	Description
	CP	Polished Chrome
	SN	Vibrant™ Polished Nickel
	PB	Vibrant™ Polished Brass
	G	Brushed Chrome
	BN	Vibrant™ Brushed Nickel
	VS	Vibrant™ Stainless
	BV	Vibrant™ Brushed Bronze
	2BZ	Oil-Rubbed Bronze
	BL	Matte Black

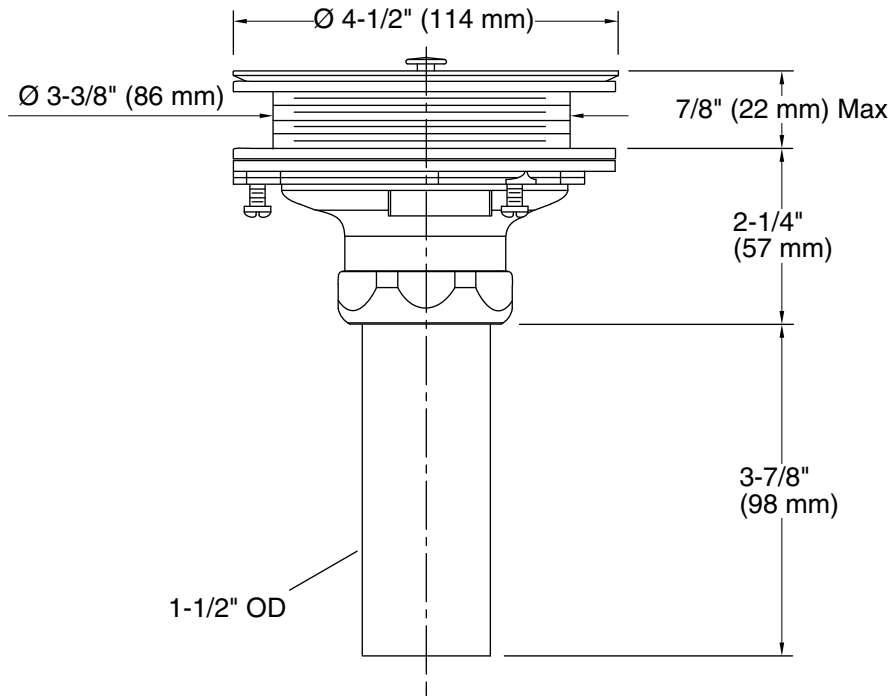

Technical Information

All product dimensions are nominal.

Notes

Install this product according to the installation guide.



**22-18 - Plumbing Fixtures-
Bathroom Toilet**

Z5675-BWL

TAG

WC-1

ARCHITECTURAL & ENGINEERING SPECIFICATION

Vitreous china, floor mounted, children's toilet with siphon jet flushing action, 10-1/2" [267mm] high elongated front rim, with 1-1/2" [38mm] top spud. This bowl is designed to perform to industry standards with as little as 1.28 gallons per flush, engineered to provide optimal performance.

PRODUCT FEATURES

- Zurn high efficiency toilets and paired performance flush valve systems are designed to exceed industry standards, while using as little as 1.28 gallons of water per flush
- Vitreous china
- Elongated front rim
- 2" fully glazed trapway
- High efficiency siphon jet flush action
- Zurn product system component compatibility and quality assurance
- Shipping weight: 42 lbs

COMPLIANCE AND CERTIFICATION:

- Complies with ASME A112.19.2 / CSA B45.1



RECOMMENDED TRIM

Z5959SS-JUV

White, open front juvenile toilet seat less cover with stainless steel check hinge

Z5972-COMB

Closet bolt & wax ring kit

See Zurn One Systems for suggested packages.

ARCHITECTURAL & ENGINEERING APPROVAL

The information contained in this document is subject to change without notice. Please contact Zurn for most up to date information.

Rough-in dimensions/Overview dimensions

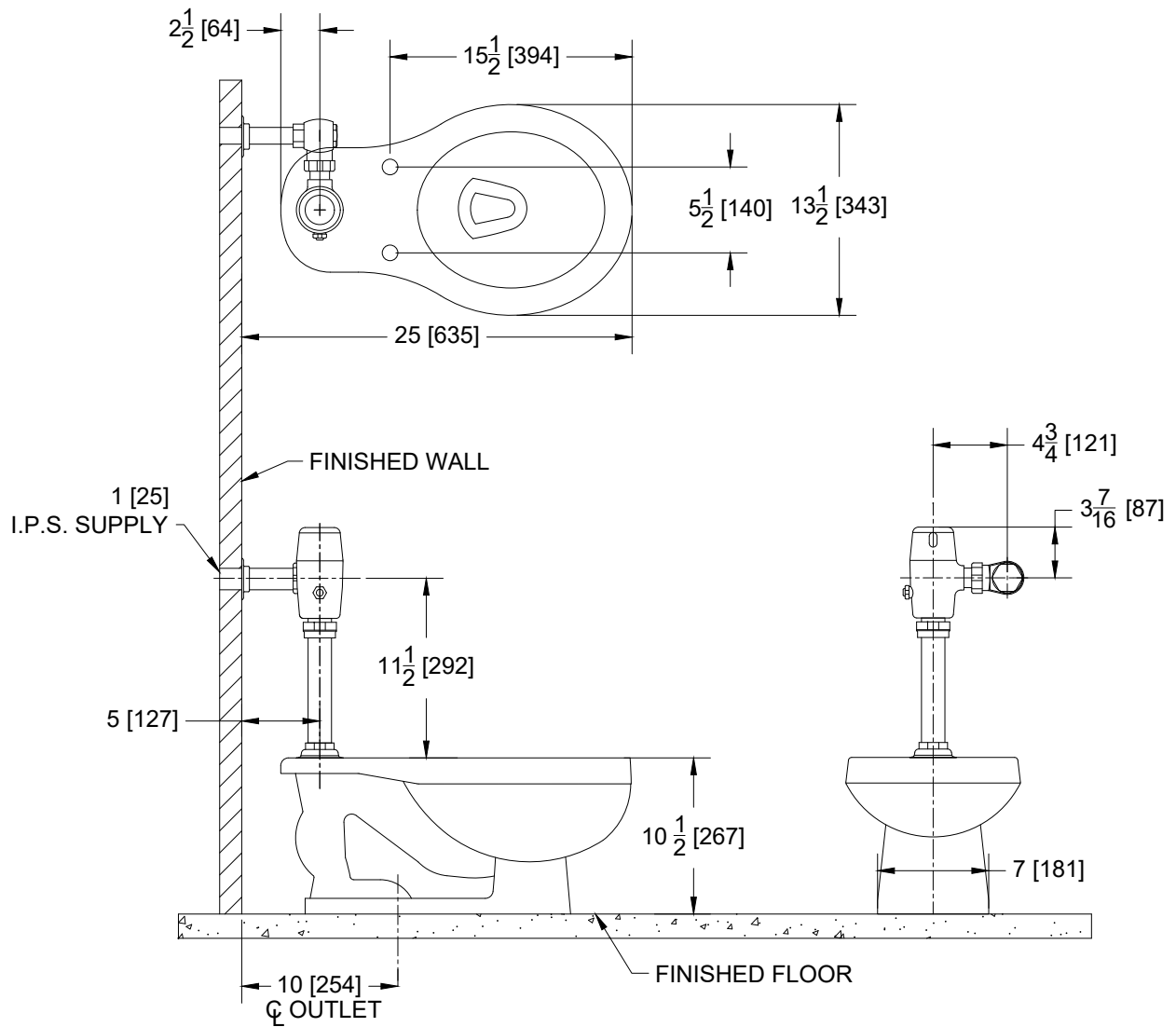

NOTE: All dimensions are for reference only. Do not use for pre-plumbing.



Z6000

Exposed Flush Valve for Water Closets

22-19 - Plumbing Fixtures - Bathroom Toilet Mixing Valve

TAG

WC-1

Architectural/Engineering Specification:

Exposed, quiet diaphragm-type, chrome plated flushometer valve with a polished exterior. Complete with a chloramine resistant, dual seal diaphragm with a clog resistant by-pass. The valve is ADA compliant with a non-hold open and no leak handle feature. Internal seals are made of chloramine resistant materials.

Product Features:

- Control Stop has internal siphon-guard protection, sweat solder kit, wall flange with set screw.
- High back pressure vacuum breaker with one piece hex coupling nut
- Chloramine resistant Internal seals
- Adjustable tailpiece
- Spud coupling and flange for top spud connection

Valve Height Options:

	Product No.	A
	Z6000	11 1/2" [292]
	Z6000-1	16" [406]
	Z6000-2	24" [610]
	Z6000-3	27" [686]

Compliance and Certification:

- ADA Compliant



*This product should be used with a WaterSense labeled counterpart with a compatible flow volume to ensure that the entire system meets the requirements for water efficiency and performance.



Flow Options:

	Flush Volume	Dual Flush	WaterSense* Labeled
-ONE**	1.1 gpf		✓
-HET**	1.28 gpf		✓
-WS1	1.6 gpf	1.6/1.1 gpf	
-Standard	3.5 gpf	3.5/2.4 gpf	

Suffix Options:

- BG BioCare Handle
- DF Dual Flush Handle (See Chart Above)
- H Handle on Front of Flush Valve
- L 1" [25] Metal Push Button
- VC Vandal Resistant Stop Cover
- YJ Split Ring Pipe Support
- YK Solid Ring Pipe Support

Upgrade Options:

- PL **Aquaflush Plus** - includes Vandal Resistant Stop Cover and Proprietary Dezincification resistant low lead brass alloy body.
- TFB Triple Filter By-pass

** Not available w/-TFB

Architectural/Engineering Approval

The information contained in this document is subject to change without notice. Please contact Zurn for most up to date information.

Rough-in/Overview dimensions

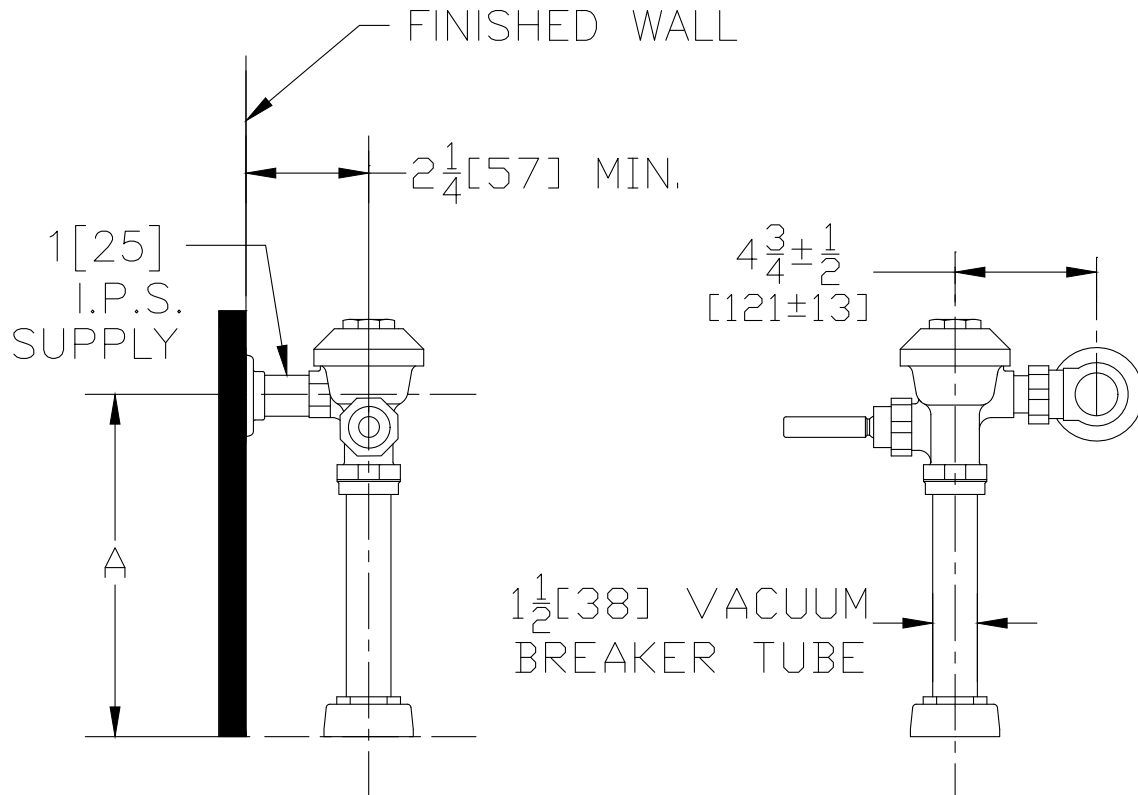



**FIRE – RATED WASHING
MACHINE OUTLET BOXES
TECHNICAL SPECIFICATION**

Item # **WWB-1**

Job Name _____ Location _____
 Engineer _____ Contractor _____
 PO # _____ Tag _____
 Representative _____

SPECIFICATIONS

Oatey Fire-Rated Washing Machine Outlet Boxes can be used in applications requiring supply valves and waste drains recessed into a fire-rated wall. Unit shall allow for the mounting of supply lines from top or bottom on the left or right side. Unit shall be available with single lever or ¼ turn brass ball valves in configurations with and without water hammer arrestors listed to ASSE 1010. Adjustable metal support bracket shall be installed on top and bottom of unit for support in stud wall. Drain size to be 2" with ¼ turn test cap.

APPROVALS AND LISTINGS

Valves	ASME A112.18.1 / CSA B125.1
Water Hammer Arrestors	ASSE 1010
Boxes	IAPMO-Listed, PS-54



ASTM E814

- 1-hour wall: 60 min. (F)
- 1-hour wall: 32 min (T)
- 2-hour wall: 120 min (F)
- 2-hour wall: 85 min (T)

CAN/ULC S115

- 1-hour wall: 60 min. (F/FH)
- 1-hour wall: 32 min (FT/FTH)
- 2-hour wall: 120 min. (F/FH)
- 2-hour wall: 85 min. (FT/FTH)

MULTIPLE VALVE INSTALLATION OPTIONS:

- Right-hand offset, bottom mount
- Right-hand offset, top mount
- Left-hand offset, bottom mount
- Left-hand offset, top mount

ADJUSTABLE MOUNTING BRACKET:

- Use nails or screws to secure into stud wall
- **Faceplate:** Snap –on faceplate accommodates up to two layers of 5/8" gypsum
- **Drain:** 2" Drain Piece fits 2" PVC or ABS Schedule 40 pipe

MATERIALS

Outlet Box	Bulk Molded Compound (BMC) Thermoset fire-rated plastic
Adjustable Mounting Bracket	Galvanized Steel
2" DWV Drain Piece	PVC
Drain Piece Metal Sleeve	Galvanized steel with Integrated intumescent pad
Plugs	Bulk Molded Compound (BMC) thermoset Fire-rated plastic
Test Cap	PVC
Box Pad	UL Classified FyreWrap Insulation Material

FyreWrap is a registered trademark of Unifrax LLC.

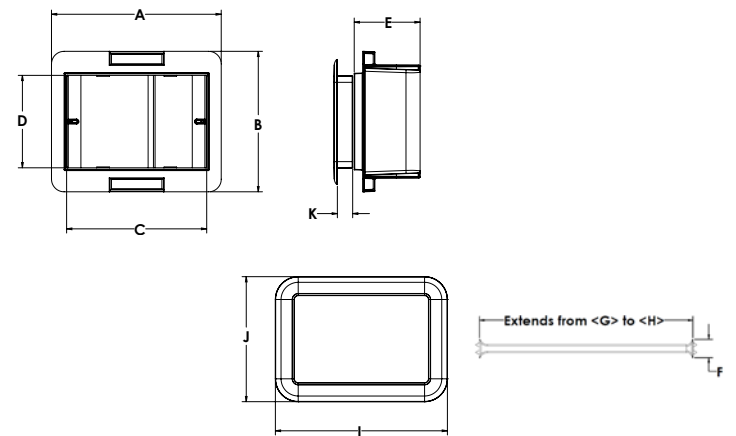

DIMENSIONS

[A]:	Box Width	10.10"	[G]:	Bracket Width	14.25"
[B]:	Box Height	8.36"	[H]:	Bracket Width	23.00"
[C]:	Box Opening Width	8.33"	[I]:	Faceplate Width	10.24"
[E]:	Box Depth	3.92"	[J]:	Faceplate Height	7.44"
[F]:	Bracket Height	1.22"	[K]:	Faceplate Depth	0.91"

Access BIM/Revit content through www.oatey.com



FIRE – RATED WASHING MACHINE OUTLET BOXES TECHNICAL SPECIFICATION

PRODUCT SELECTOR

FIRE – RATED WASHING MACHINE OUTLET BOXES			
✓	Product Number	Description	CTN. QTY.
	38470	¼ Turn Brass Ball Valve, Copper Sweat, Standard Pack	1
	38471	¼ Turn Brass Ball Valve, CPVC, Standard Pack	1
	38472	¼ Turn Brass Ball Valve, ½" ASTM F1807 PEX, Standard Pack	1
	38473	¼ Turn Brass Ball Valve, ½" ASTM F1960 PEX, Standard Pack	1
	38474	Single Lever Brass Ball Valve, Copper Sweat, Standard Pack	1
	38475	Single Lever Brass Ball Valve, CPVC, Standard Pack	1
	38476	Single Lever Brass Ball Valve, ½" ASTM F1807 PEX, Standard Pack	1
	38477	Single Lever Brass Ball Valve, ½" ASTM F1960 PEX, Standard Pack	1
	38478	¼ Turn Brass Ball Valve with Water Hammer Arrestor, Copper Sweat, Standard Pack	1
	38479	¼ Turn Brass Ball Valve with Water Hammer Arrestor, CPVC, Standard Pack	1
	38480	¼ Turn Brass Ball Valve with Water Hammer Arrestor, ½" ASTM F1807 PEX, Standard Pack	1
	38481	¼ Turn Brass Ball Valve with Water Hammer Arrestor, ½" ASTM F1960 PEX, Standard Pack	1
	38482	Single Lever Brass Ball Valve with Water Hammer Arrestor, Copper Sweat, Standard Pack	1
	38483	Single Lever Brass Ball Valve with Water Hammer Arrestor, CPVC, Standard Pack	1
	38484	Single Lever Brass Ball Valve with Water Hammer Arrestor, ½" ASTM F1807 PEX, Standard Pack	1
	38485	Single Lever Brass Ball Valve with Water Hammer Arrestor, ½" ASTM F1960 PEX, Standard Pack	1
ACCESSORIES			
	38494	Plain Washing Machine Outlet Box, without faceplate or brackets	1
	38496	Washing Machine Outlet Box Faceplate	1
	38498	Adjustable Metal Support Bracket, 2-pieces	1
	38576	Washing Machine Outlet Box Test Cap	1

SPD, ASPD Square Plaque Diffuser

CD-1

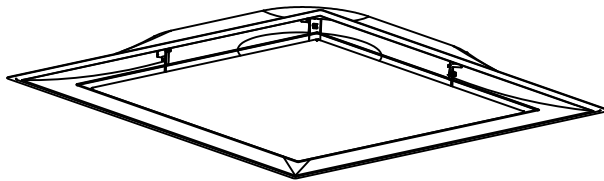
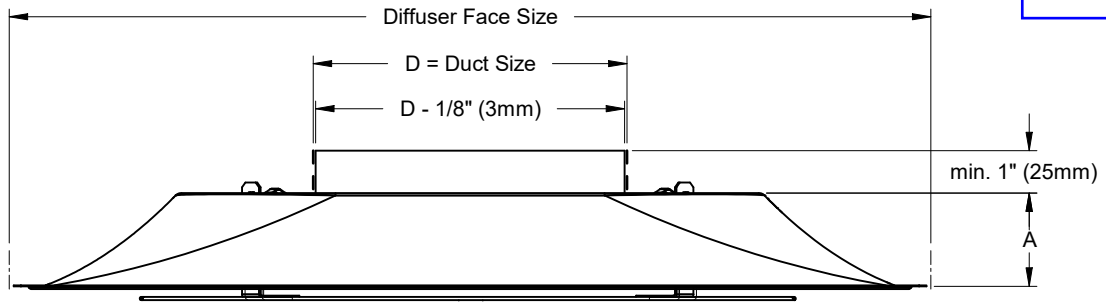

OPTIONS:

- R6 - Insulated Backpan (style 31 or 4TS N/A with 20"x20" or 500mm x 500mm)
- AFI - 1/2" fiberglass with foil / scrim vapor barrier insulated backpan (style 31, 20"x20" or 500mm x 500mm only)
- BN - Beaded Inlet Neck with extended depth 2 1/2" (64mm). Not available on ASPD.
- MRI - aluminum construction. Available for ASPD 24"x24" & 600mm x 600mm, styles 31 & 17 only. Not available with dampers EHT or air baffles.
- Hangers
 - Integral hanger loops (standard)
 - EHT - Extended hanger tabs

STANDARD CONSTRUCTION:

- SPD - Steel construction
- ASPD - Aluminum construction

FINISH:

- B12 - Standard White
- Optional Finishes Available:
 - Optional colors
 - Custom colors
 - Woodgrain patterns (ASPD only)
 - Armstrong coordinated finishes

See finishes brochure for additional information. Contact your PRICE representative for leadtimes and pricing

NOTES:

- 20" x 20" & 500mm x 500mm available in style 31 only
- ASPD available with style 31 and 17 only
- Dampers and air baffles ship loose
- For 9/16" flat tee installation with style 31 frame, cross-tees must be firmly secured. Locking any unopposed cross tees to the main beam with clips such as Armstrong STAC is recommended. Corner clips from ceiling suppliers may also be used, or order 916 clip in GRD-PARTS (confirming fit with ceiling on site is recommended).
- Factory tolerance ± 1/32" (1mm)

DAMPERS:

- VCR7 - Radial opposed blade steel damper (N/A with 4", 5", or 7" inlets)
- VCR8 - Full flow duct mounted steel damper
- VCR8E - Full flow diffuser mounted steel damper
- VCR9 - Radial diffuser mounted steel damper (N/A with 4", 5", 7", or 15" inlets)

Diffuser Face Size	Ceiling Opening	A	Duct Size											
			4"	5"	6"	7"	8"	10"	12"	14"	15"			
12" x 12"	10 1/2" x 10 1/2"	1 1/8"	•	•	•	•	•							
20" x 20"	18" x 18"	2 1/2"			•	•	•	•	•					
24" x 24"	22" x 22"	2 1/2"			•	•	•	•	•	•	•	•	•	•
300mm x 300mm	249mm x 249mm	29mm	•	•	•	•	•							
500mm x 500mm	449mm x 449mm	64mm			•	•	•	•						
600mm x 600mm	549mm x 549mm	64mm			•	•	•	•	•	•	•	•	•	•

• indicates available inlet size

AIR PATTERN:

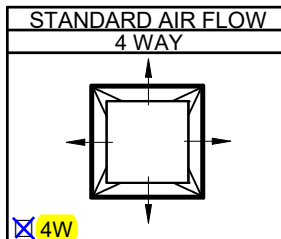

with AB air baffles (steel):

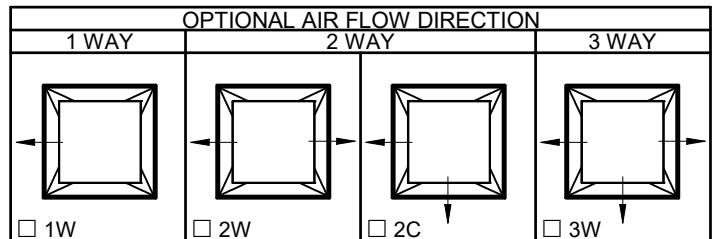

ALL METRIC DIMENSIONS () ARE SOFT CONVERTED. IMPERIAL DIMENSIONS ARE CONVERTED TO METRIC AND ROUNDED TO THE NEAREST MILLIMETER.

PROJECT:		 SPD / ASPD SQUARE PLAQUE DIFFUSER
ENGINEER:		
CUSTOMER:		
SUBMITTAL DATE:		
SPEC. SYMBOL:		2022-06-23

SPD, ASPD Square Plaque Diffuser

Lay-in & Surface Mount Frames:

<p><input type="checkbox"/> 31 - 15/16" T-Bar Lay-In</p> <p>Ceiling Module = Diffuser Face Size Overall = Face Size - 1/4" (6mm) 15/16"</p>	<p><input type="checkbox"/> 31 - Surface Mount</p> <p>Ceiling Opening Diffuser Face Size - 1/4" (6mm)</p>
<p><input type="checkbox"/> 17 - 9/16" Bolt Slot T-bar</p> <p>Ceiling Module = Diffuser Face Size 5/16" 9/16"</p>	<p><input type="checkbox"/> 17 - 9/16" Tegular T-Bar</p> <p>Ceiling Module = Diffuser Face Size 5/16" 9/16"</p>
<p><input type="checkbox"/> 15 - 15/16" Tegular T-Bar (24" x 24" only)</p> <p>Ceiling Module = Diffuser Face Size 15/16"</p>	<p><input type="checkbox"/> 2 - Snap-In</p> <p>Ceiling Module = Diffuser Face Size 13/16"</p>
<p><input type="checkbox"/> AV - for Armstrong Vector (24" x 24" and 600mm x 600mm only)</p> <p>Ceiling Module = Diffuser Face Size 15/16" Overall = Face Size - 1/4" (6mm)</p>	<p><input type="checkbox"/> AM - for ARMSTRONG METALWORKS Torsion Spring Ceilings (24"x24" only)</p> <p>Ceiling Module = Diffuser Face Size 1 1/2" Overall = Face Size - 1/8" (3mm)</p>
<p><input type="checkbox"/> 4TS - for Certainteed Techstyle (24"x24" only)</p> <p>Ceiling Module = Diffuser Face Size 1 1/8" 1/4"</p>	<p><input type="checkbox"/> 4 - Spline</p> <p>Ceiling Module = Diffuser Face Size 3/8" Tile spline on two opposite sides T-bar clip on two opposite sides</p>

ALL METRIC DIMENSIONS () ARE SOFT CONVERTED. IMPERIAL DIMENSIONS ARE CONVERTED TO METRIC AND ROUNDED TO THE NEAREST MILLIMETER.

PROJECT:		
ENGINEER:		
CUSTOMER:	<p>218786</p>	<p>SPD / ASPD SQUARE PLAQUE DIFFUSER</p>
SUBMITTAL DATE:	SPEC. SYMBOL:	

SPD, ASPD Square Plaque Diffuser

Lay-in Panels: Available in SPD only

3P - 15/16" T-Bar Lay-In

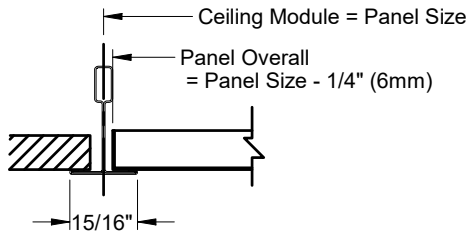

15P - 15/16" Tegular T-bar

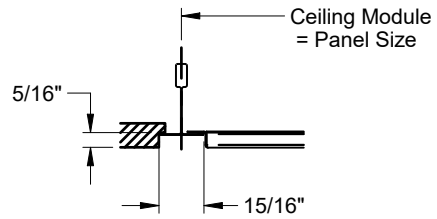

17P - 9/16" Bolt Slot T-bar

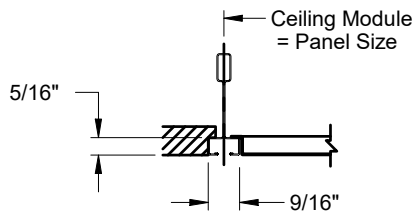

17P - 9/16" Tegular T-Bar

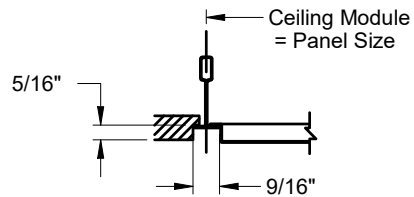

AVP - Armstrong Vector Panel

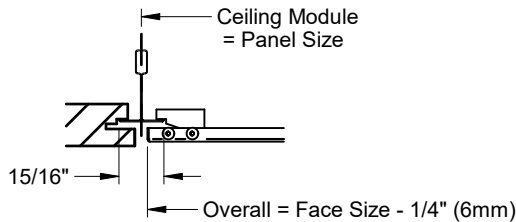

2P - Snap-In

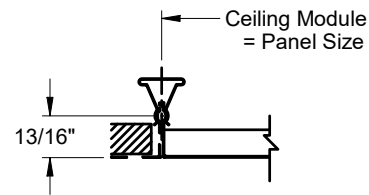

4P - Spline

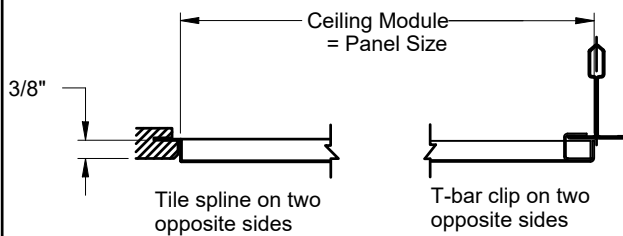

PANEL SIZE:

12" x 12" face size:

- 24" x 12" panel
- 16" x 16" panel
- 20" x 20" panel
- 24" x 24" panel
- 48" x 12" panel

300mm x 300mm face size:

- 600mm x 300mm panel
- 400mm x 400mm panel
- 500mm x 500mm panel
- 600mm x 600mm panel
- 1200mm x 300mm panel

24" x 24" face size:

- 30" x 30" panel
- 48" x 24" panel

600mm x 600mm face size:

- 750mm x 750mm panel
- 1200mm x 750mm panel

- Styles 15P and AVP panels available in 12"/300mm face sizes, 24" x 12", 24" x 24", 600mm x 300mm and 600mm x 600mm panel sizes only



Scan for link to additional product information

ALL METRIC DIMENSIONS () ARE SOFT CONVERTED. IMPERIAL DIMENSIONS ARE CONVERTED TO METRIC AND ROUNDED TO THE NEAREST MILLIMETER.

PROJECT:

ENGINEER:

CUSTOMER:

SUBMITTAL DATE:

SPEC. SYMBOL:



MG

218786

2022-06-23

**SPD / ASPD
SQUARE PLAQUE
DIFFUSER**

PCA-A24KA8 & PUZ-A24NHA7
24,000 BTU/H CEILING-SUSPENDED INDOOR UNIT
24,000 BTU/H HEAT PUMP UNIVERSAL OUTDOOR



Job Name:

System Reference:

Date:



HP-1,-2

Indoor Unit.....PCA-A24KA8

CU-1,-2

Outdoor Unit.....PUZ-A24NHA7



INDOOR UNIT FEATURES

- Airflow settings for high and low ceiling applications
- Knock-out for outside-air intake
- Optional i-see Sensor™ for air distribution and energy saving
- Auto fan speed mode
- Filter status indicator
- Easy-to-clean, washable filter
- Suspends from ceiling for quick and easy installation
- Ideal for larger retail stores, classrooms, and restaurants
- Multiple control options available:
 - kumo cloud® smart device app for remote access
 - Third-party interface options
 - Wired or wireless controllers

OUTDOOR UNIT FEATURES

- Variable speed INVERTER-driven compressor
- Pre-charged with refrigerant volume for piping length up to 70 ft
- Low ambient cooling down to 0°F providing 100% capacity
- 24-hour continuous operation (cooling mode)
- High pressure protection
- Fast restart
- Superior energy and operational efficiency
- Seacoast protection*
 - External Outer Panel: Phosphate coating + Acrylic-Enamel coating
 - Fan Motor Support: Epoxy resin coating (at edge face)
 - Separator Assembly Valve Bed: Epoxy resin coating (at edge face)
 - Blue Fin treatment is an anti-corrosion treatment that is applied to the Heat exchanger coil to protect it against airborne contaminants.
 - Heat exchanger coil and base panel rated for 2,000 hours in accordance with ASTM B117 testing

*Seacoast protection standard from 2022 production

SPECIFICATIONS: PCA-A24KA8 & PUZ-A24NHA7

Cooling at 95°F ¹	Maximum Capacity	BTU/H	24,000
	Rated Capacity	BTU/H	24,000
	Minimum Capacity	BTU/H	10,000
	Maximum Power Input	W	1,960
	Rated Power Input	W	1,960
	Moisture Removal	Pints/h	5.8
	Sensible Heat Factor		0.73
Heating at 47°F ²	Power Factor [208V / 230V]	%	94.7 / 94.7
	Maximum Capacity	BTU/H	28,000
	Rated Capacity	BTU/H	26,000
	Minimum Capacity	BTU/H	8,800
	Maximum Power Input	W	2,230
	Rated Power Input	W	1,800
Heating at 17°F ³	Power Factor [208V / 230V]	%	94.3 / 94.3
	Maximum Capacity	BTU/H	17,900
	Rated Capacity	BTU/H	15,400
	Maximum Power Input	W	1,770
Heating at 5°F ⁴	Rated Power Input	W	1,700
	Maximum Capacity	BTU/H	14,900
Efficiency	Maximum Power Input	W	1,900
	SEER2		21.0
	EER2 ¹		12.2
	HSPF2 [IV]		9.2
	COP at 47°F ²		4.23
	COP at 17°F at Maximum Capacity ³		2.97
Electrical	COP at 5°F at Maximum Capacity ⁴		2.3
	ENERGY STAR® Certified		Yes
	Voltage, Phase, Frequency		208/230, 1, 60
	Guaranteed Voltage Range	V AC	198 - 253
	Voltage: Indoor - Outdoor, S1-S2	V AC	208/230
	Voltage: Indoor - Outdoor, S2-S3	V DC	24
	Short-circuit Current Rating [SCCR]	kA	5
	Recommended Fuse/Breaker Size (Outdoor)	A	25
	Recommended Wire Size [Indoor - Outdoor]	AWG	14
	Power Supply		Indoor unit is powered by the outdoor unit
Indoor Unit	MCA	A	1.0
	Fan Motor Full Load Amperage	A	0.54
	Fan Motor Output	W	95
	Fan Motor Type		DC Motor
	Airflow Rate at Cooling, Dry	CFM	530-565-600-670
	Airflow Rate at Cooling, Wet	CFM	495-530-565-635
	Airflow Rate at Heating, Dry	CFM	530-565-600-670
	Sound Pressure Level [Cooling]	dB[A]	33-35-37-40
	Sound Pressure Level [Heating]	dB[A]	33-35-37-40
	Drain Pipe Size	In. [mm]	1-1/32 [26]
	Coating on Heat Exchanger		—
	External Finish Color		White Munsell 6.4Y 8.9/0.4
	Unit Dimensions	W x D x H: In. [mm]	50-3/8 x 26-3/4 x 9-1/16 [1,280 x 680 x 230]
	Package Dimensions	W x D x H: In. [mm]	53-7/64 x 30 x 12-41/64 [1,349 x 760 x 321]
Unit Weight	Lbs. [kg]	71 [32]	
Package Weight	Lbs. [kg]	80 [36]	
Indoor Unit Operating Temperature Range	Cooling Intake Air Temp [Maximum / Minimum]*	°F	90 DB, 73 WB / 66 DB, 59 WB
	Heating Intake Air Temp [Maximum / Minimum]	°F	82 DB / 50 DB

NOTES:

AHRI Rated Conditions (Rated data is determined at a fixed compressor speed)	¹ Cooling (Indoor // Outdoor)	°F	80 DB, 67 WB // 95 DB, 75 WB
	² Heating at 47°F (Indoor // Outdoor)	°F	70 DB, 60 WB // 47 DB, 43 WB
	³ Heating at 17°F (Indoor // Outdoor)	°F	70 DB, 60 WB // 17 DB, 15 WB

Conditions	⁴ Heating at 5°F (Indoor // Outdoor)	°F	70 DB, 60 WB // 5 DB, 4 WB
------------	---	----	----------------------------

*Indoor/Outdoor Unit Operating Temperature Range (Cooling Air Temp [Maximum / Minimum]):

- Applications should be restricted to comfort cooling only; equipment cooling applications are not recommended for low ambient temperature conditions.
 - » Wind baffles required to operate below 23°F DB in cooling mode.
 - » Heat pump system with wind baffle: 0°F - 115°F.
 - » Refer to wind baffle documentation for further information.

**Outdoor Unit Operating Temperature Range (Cooling Thermal Lock-out / Re-start Temperatures; Heating Thermal Lock-out / Re-start Temperatures):

- System cuts out in heating mode to avoid thermistor error and automatically restarts at these temperatures.

***Blue Fin Coating Standard from 2022 production:

- PU(Y/Z)-A(12/18)NKA7 - Beginning with serial number 12U*****
- PU(Y/Z)-A(24/30/36/42)NKA7 - Beginning with serial number 12U*****

SPECIFICATIONS: PCA-A24KA8 & PUZ-A24NHA7

Outdoor Unit	MCA	A	19.0
	MOCP	A	26
	Fan Motor Full Load Amperage	A	0.4
	Fan Motor Output	W	86
	Airflow Rate [Cooling / Heating]	CFM	1940 / 1940
	Refrigerant Control		LEV
	Defrost Method		Reverse Cycle
	Coating on Heat Exchanger		Blue Fin Coating***
	Sound Pressure Level, Cooling ¹	dB(A)	47
	Sound Pressure Level, Heating ²	dB(A)	48
	Compressor Type		INVERTER-driven twin rotary
	Compressor Model		SNB172FWHM1
	Compressor Rated Load Amps	A	7
	Compressor Locked Rotor Amps	A	11.0
	Compressor Oil [Type // Charge]	oz.	FV50S // 23
	External Finish Color		Ivory Munsell 3Y 7.8/1.1
	Base Pan Heater		N/A
	Unit Dimensions	W x D x H: In. [mm]	37-13/32 x 13 (+1-3/16) x 37-1/8 [950 x 330 (+30) x 943]
	Package Dimensions	W x D x H: In. [mm]	40-15/16 x 17-11/16 x 40-11/16 [1040 x 450 x 1033]
	Unit Weight	Lbs. [kg]	153 [69]
Package Weight	Lbs. [kg]	179 [81]	
Outdoor Unit Operating Temperature Range	Cooling Air Temp [Maximum / Minimum]*	°F	115 DB / 0 DB
	Heating Air Temp [Maximum / Minimum]	°F	70 DB, 59 WB / -4 DB, -4 WB
	Heating Thermal Lock-out / Re-start Temperatures**	°F	-13 / -4
Refrigerant	Type		R410A
	Pre-Charged Refrigerant Amount	Lbs, oz	7.0, 11.0
	Maximum Pre-Charged Piping Length	Ft. [m]	70.0 [20.0]
	Additional Refrigerant Charge Per Additional Piping Length	oz./Ft. [g/m]	0.7 [50]
Piping	Gas Pipe Size O.D. [Flared]	In.[mm]	5/8 [15.88]
	Liquid Pipe Size O.D. [Flared]	In.[mm]	3/8 [9.52]
	Maximum Piping Length	Ft. [m]	165 [50]
	Maximum Height Difference	Ft. [m]	100 [30]
	Maximum Number of Bends		15

NOTES:

AHRI Rated Conditions

(Rated data is determined at a fixed compressor speed)

¹Cooling (Indoor // Outdoor) °F 80 DB, 67 WB // 95 DB, 75 WB
²Heating at 47°F (Indoor // Outdoor) °F 70 DB, 60 WB // 47 DB, 43 WB
³Heating at 17°F (Indoor // Outdoor) °F 70 DB, 60 WB // 17 DB, 15 WB

Conditions

⁴Heating at 5°F (Indoor // Outdoor) °F 70 DB, 60 WB // 5 DB, 4 WB

*Indoor/Outdoor Unit Operating Temperature Range (Cooling Air Temp [Maximum / Minimum]):

- Applications should be restricted to comfort cooling only; equipment cooling applications are not recommended for low ambient temperature conditions.
 - » Wind baffles required to operate below 23°F DB in cooling mode.
 - » Heat pump system with wind baffle: 0°F - 115°F.
 - » Refer to wind baffle documentation for further information.

**Outdoor Unit Operating Temperature Range (Cooling Thermal Lock-out / Re-start Temperatures; Heating Thermal Lock-out / Re-start Temperatures):

- System cuts out in heating mode to avoid thermistor error and automatically restarts at these temperatures.

***Blue Fin Coating Standard from 2022 production:

- PU(Y/Z)-A(12/18)NKA7 - Beginning with serial number 12U*****
- PU(Y/Z)-A(24/30/36/42)NKA7 - Beginning with serial number 12U*****

INDOOR UNIT ACCESSORIES: PCA-A24KA8

Control Interface	CN24 Relay Kit	CN24RELAY-KIT-CM3
	IT Extender	PAC-WHS01IE-E
	kumo station® for kumo cloud®	PAC-WHS01HC-E
	Procon BACnet® and Modbus® Interface	PAC-UKPRC001-CN-1
	Remote Operation Adapter†	PAC-SF40RM-E
	Thermostat Interface	PAC-US445CN-1
	USNAP Adapter	PAC-WHS01UP-E
Remote Sensor	Flush Mount Remote Temperature Sensor	PAC-USSEEN002-FM-1
	Remote Temperature Sensor	PAC-SE41TS-E
	Wireless temperature and humidity sensor for kumo cloud®	PAC-USWHS003-TH-1
Wired Remote Controller	Deluxe Wired MA Remote Controller†	PAR-40MAAU
	Simple Ductless Wired Remote Controller	PAC-SDW01RC-1
	Simple MA Remote Controller†	PAC-YT53CRAU-J
	Touch MA Controller†	PAR-CT01MAU-SB
Wireless Remote Controller	kumo touch™ RedLINK™ Wireless Controller	MHK2
	Lockdown bracket for remote controller	RCMKP1CB
	Wireless MA Receiver	PAR-FA32MA-W
	Wireless MA Remote Controller	PAR-FL32MA-E
	Wireless Receiver Kit	PAR-SL93B-E
	Wireless Receiver Kit with i-See sensor™	PAR-SA92MW-E
Condensate	Blue Diamond (Advanced) Mini Condensate Pump w/ Reservoir & Sensor (208/230V) [recommended]	X87-721
	Blue Diamond (MegaBlue Advanced) Condensate Pump w/ Reservoir & Sensor	X87-835
	Refco Condensate Pump (100-240 VAC) up to 120,000 BTU/H	COMBI
Disconnect Switch	(30A/600V/UL) [fits 2" X 4" utility box] - Black	TAZ-MS303
Filter	65% Medium Efficiency Filter (MERV 8)	PAC-SH89KF-E
Lineset	10' x 3/8" x 10' x 5/8" Lineset (Twin-Tube Insulation)	MPLS385812T-10
	100' x 3/8" x 100' x 5/8" Lineset (Twin-Tube Insulation)	MPLS385812T-100
	15' x 3/8" x 15' x 5/8" Lineset (Twin-Tube Insulation)	MPLS385812T-15
	30' x 3/8" x 30' x 5/8" Lineset (Twin-Tube Insulation)	MPLS385812T-30
	50' x 3/8" x 50' x 5/8" Lineset (Twin-Tube Insulation)	MPLS385812T-50
	65' x 3/8" x 65' x 5/8" Lineset (Twin-Tube Insulation)	MPLS385812T-65

NOTES:

†PAC-SF40RM-E (Unable to use with wireless remote controller)

OUTDOOR UNIT ACCESSORIES: PUZ-A24NHA7

Air Outlet Guide	Air Outlet Guide (1 Piece)	PAC-SG59SG-E
Centralized Drain Pan	Centralized Drain Pan	PAC-SG63DP-E
	Drain Pan	PAC-SG64DP-E
Control/Service Tool	Control/Service Tool	PAC-SK52ST
	M- & P-Series Maintenance Tool Cable Set	M21EC0397
	USB/UART Conversion Cable (Required for all laptop connection)	M21EC1397
Hail Guards	Hail Guard	HG-A6
M-NET Converter	M-NET Converter	PAC-SJ85MA-E
	M-NET Converter	PAC-SJ95MA-E
Mini-Split Wire	14 Gauge, 4 wire MiniSplit Cable—250 ft. roll	S144-250
	14 Gauge, 4 wire MiniSplit Cable—50 ft. roll	S144-50
	16 Gauge, 4 wire MiniSplit Cable—250 ft. roll	S164-250
	16 Gauge, 4 wire MiniSplit Cable—50 ft. roll	S164-50
Mounting Pad	Condensing Unit Mounting Pad: 24" x 42" x 3"	ULTRILITE2
Stand	18" Single Fan Stand	QSMS1801M
	24" Single Fan Stand	QSMS2401M
	Condenser Wall Bracket	QSWB2000M-1
	Condenser Wall Bracket - Stainless Steel Finish	QSWBSS
	Outdoor Unit Stand — 12" High	QSMS1201M
Wind Baffle	Front Wind Baffle	WB-PA5
	Rear Wind Baffle	WB-RE5
	Side Advanced Wind Baffle	WB-SD5

INDOOR UNIT DIMENSIONS: PCA-A24KA8

Unit: inch (mm)

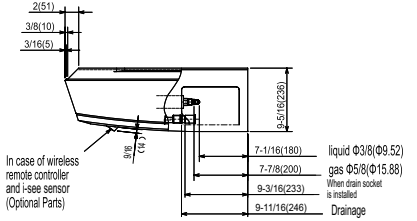
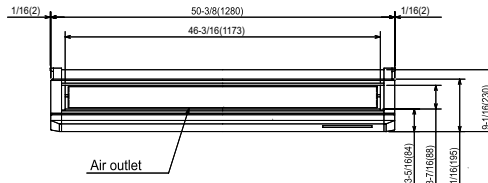
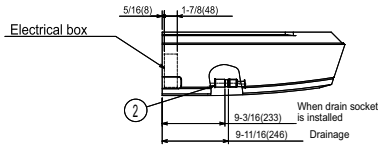
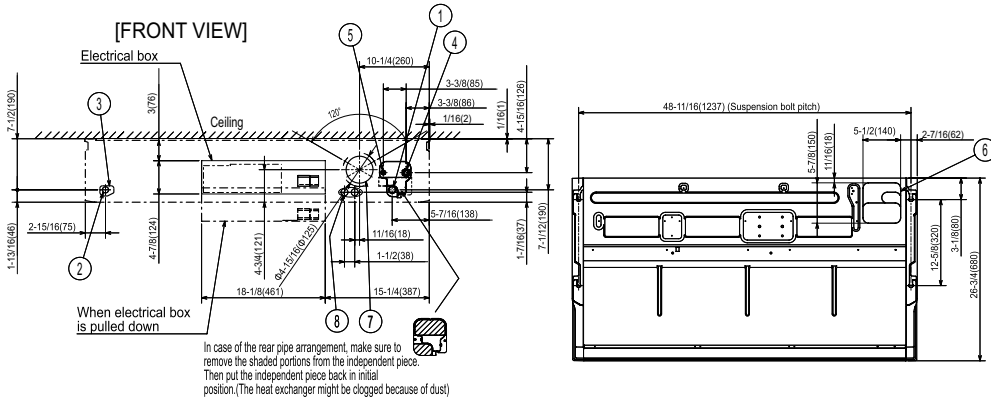

- ① Drainage pipe connection(1(26mm)I.D.)
- ② Drainage pipe connection(for the left arrangement)
- ③ Knockout hole for left drain-piping arrangement
- ④ Refrigerant-pipe connection(gas pipe side/flared connection)
- ⑤ Refrigerant-pipe connection(liquid pipe side/flared connection)
- ⑥ Knockout hole for upper drain pipe arrangement
- ⑦ Knockout hole for fresh air intake Φ3-15/16(Φ100)
- ⑧ Knockout hole for wiring arrangement Φ7/8(Φ22)
Accessory...Drain socket (1(26mm) I.D.)

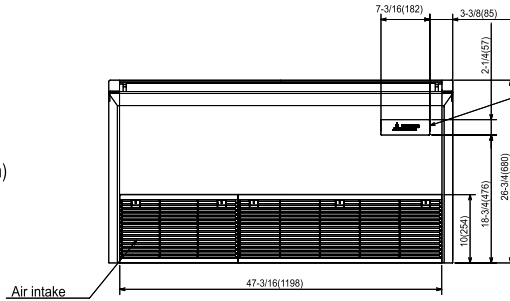

In case of wireless remote controller and i-see Sensor(Optional Parts)

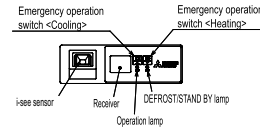

NOTES.

1. Use M10 or W3/8 screw for anchor bolt.
2. Please be sure when installing the drain pump (option parts), refrigerant pipe will be only upward.

OUTDOOR UNIT DIMENSIONS: PUZ-A24NHA7

Unit: mm<in>

1 FREE SPACE (Around the unit)

The diagram below shows a basic example. Explanation of particular details are given in the installation manuals etc.

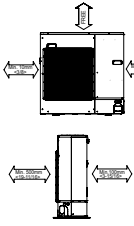

2 SERVICE SPACE

Dimensions of space needed for service access are shown in the below diagram.

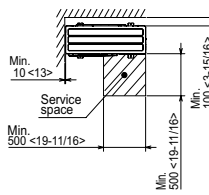

3 FOUNDATION BOLTS

Please secure the unit firmly with 4 foundation (M10<W3/8>) bolts. (Bolts and washers must be purchased locally.)

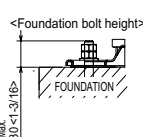

4 PIPING-WIRING DIRECTIONS

Piping and wiring connections can be made from 4 directions: FRONT, Right, Rear and Below.

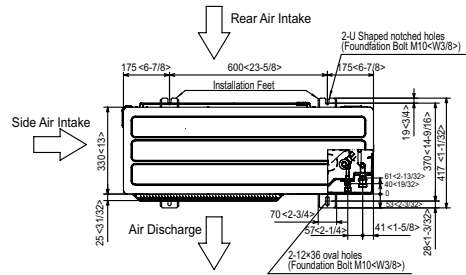

Example of Notes

- ① ... Refrigerant GAS pipe connection (FLARE) ø15.88(5/8F)
- ② ... Refrigerant LIQUID pipe connection (FLARE) ø9.52(3/8F)
- *1... Indication of STOP VALVE connection location.

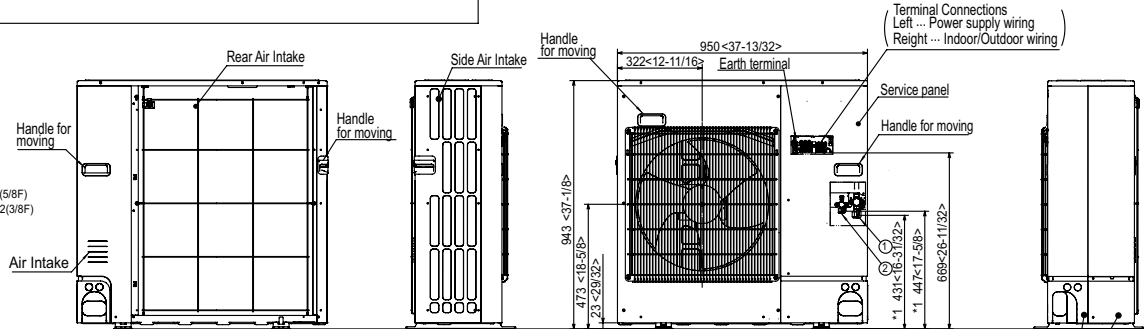

Piping knockout Hole Details

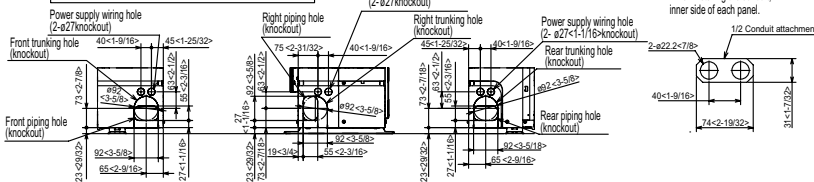

Set the attachment to the When installing the conduit, inner side of each panel.

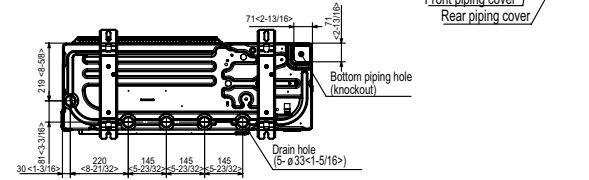

1340 Satellite Boulevard Suwanee, GA 30024
Toll Free: 800-433-4822 www.mehvac.com



FORM# PCA-A24KA8 & PUZ-A24NHA7 - 202402

WB-PA5
Front Wind Baffle



Job Name:

System Reference:

Date:



CU-1,-2

GENERAL FEATURES

- Front Wind Baffles allow outdoor units to operate at full capacity down to the temperature ranges shown in the table below.
- Prevents wind from reversing outdoor fan rotation when unenergized.
- Durable and low maintenance construction.

PLEASE NOTE

- Install outdoor units with the back surface facing wall side to eliminate the effects of external wind
- Outdoor units should not be installed in an orientation or site where the wind blows directly at the back of the unit
- Wind baffle should not be used where there is any obstacle at either side or above the outdoor unit as the discharged air will be blocked
- Refer to outdoor unit for detailed installation instructions

SPECIFICATIONS

Exterior			
Color	Surface Treatment	Material	Weight
Matches P-Series Outdoor Unit (Ivory Munsell 3Y 7.8/1.1)	Polyester Powder Coating	Alloy Hot-Dip Zinc Coated Carbon Steel Sheet	8 Lbs. 8 Oz.

APPLICATION

- The Wind Baffles are used to extend the cooling temperature operation range of the PUY, PUZ and MXZ models
- The information below outlines which wind baffles to utilize per required operation range
- Please refer to the installation manual of the appropriate outdoor unit for correct installation requirements

COOLING TEMPERATURE OPERATION RANGE WITH WIND BAFFLES

Model Series	Operation Range Without Wind Baffles	Front Wind Baffles	Front + Advanced Side + Advanced Rear Wind Baffles
PUZ-7	23°F - 115°F	0°F	N/A
PUY-7	23°F - 115°F	0°F	-40°F
MXZ	23°F - 115°F	0°F	N/A

**If unit is exposed without wall surfaces surrounding for protection from wind, then side and rear wind baffles will be required. Please refer to installation dimensions and outdoor unit installation manual for appropriate requirements.

COMPATIBILITY

Single Zone	WB-PA5 (Qty)
PUY-A24NHA7(-BS)	1
PUY-A30NHA7(-BS)	1
PUZ-A24NHA7(-BS)	1
PUZ-A30NHA7(-BS)	1
PUZ-HA24NHA1	1

APPENDIX - PREVIOUS GENERATION COMPATIBILITY

Models	Front Wind Baffles				Advanced Side Wind Baffles			Advanced Rear Wind Baffles		
	WB-PA1	WB-PA2 ⁽¹⁾	WB-PA3	WB-PA5	WB-SD1	WB-SD2 ⁽²⁾	WB-SD3	WB-RE1	WB-RE2 ⁽³⁾	WB-RE3
PUY/Z-A-A12NHA4	1									
PUY/Z-A-A18NHA4	1									
PUY/Z-A-A24NHA4		1								
PUY/Z-A-A30NHA4		1								
PUY/Z-A-A36NHA4		1								
PUY/Z-A-A42NHA4		2								
PUY/Z-A-A42NHA5		2								
PUZ-HA30NHA4		2								
PUZ-HA36NHA4		2								
PUMY-P36NHMU				2						
PUMY-P36NKMU1			2							
PUMY-P48NHMU				2						
PUMY-P48NKMU1			2							
PUMY-P60NKMU1			2							
PUY/Z-A12NHA6	1				1			1		
PUY/Z-A18NHA6	1				1			1		
PUY/Z-A24NHA6		1				1			1	
PUY/Z-A30NHA6		1				1			1	
PUY/Z-A36NHA6		1				1			1	
PUY/Z-A42NHA6		2					1			1

⁽¹⁾WB-PA2 is replaced by WB-PA5

⁽²⁾WB-SD2 is replaced by WB-SD5

⁽³⁾WB-RE2 is replaced by WB-RE5

COOLING TEMPERATURE OPERATION RANGE WITH WIND BAFFLES

Model Series	Operation Range Without Wind Baffles	Front Wind Baffles	Front + Advanced Side + Advanced Rear Wind Baffles
PUZ-4	23°F - 115°F	0°F	N/A
PUY-4	23°F - 115°F	0°F	N/A
PUZ-5	23°F - 115°F	0°F	N/A
PUY-5	23°F - 115°F	0°F	N/A
PUZ-6	23°F - 115°F	0°F	N/A
PUY-6*	23°F - 115°F	0°F	-20°F
PUMY**	23°F - 115°F	5°F	N/A

*PUY-A42NHA6 units do not have the extended cooling range below 0° F

**Operation range varies based on indoor unit connected, refer to service manual for applicable indoor units

DIMENSIONS: WB-PA5

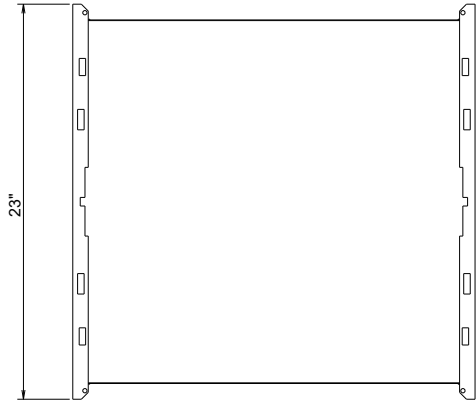

Requirements of space for installation

(1) One unit installation:

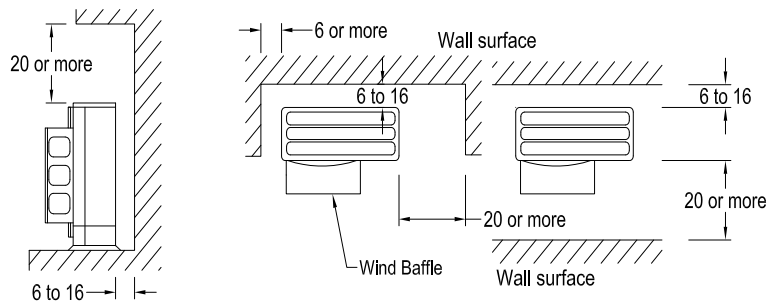

(2) Multiple Unit Installation: Installation of multiple units in series must be no more than five units.

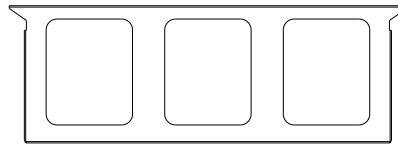
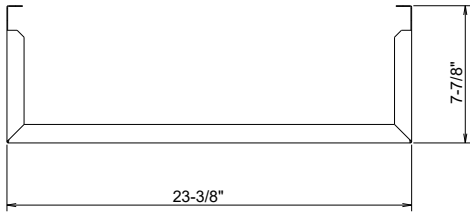
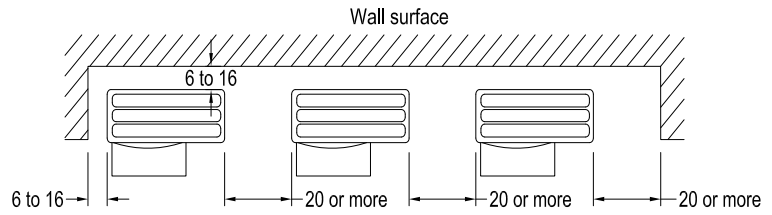

ALL DIMENSIONS IN INCHES
ALL DIMENSION $\pm \frac{1}{32}$ "

1340 Satellite Boulevard Suwanee, GA 30024
Toll Free: 800-433-4822 www.mehvac.com

Specification Submittal Data / Panasonic Ventilation Fan

Description

Customizable ceiling mount ventilating fan, low sone and rated for continuous operation. NGBS certified. ENERGY STAR[®] rated and certified by the Home Ventilating Institute (HVI). Evaluated by the Underwriters Laboratories and conforms to both UL and cUL standards.

Motor/Blower:

- Enclosed brushless ECM smart motor technology rated for continuous operation
- Adjustable ventilation rates at 50 – 80 – 110 CFM
- Power rating of 120 volts and 60 Hz
- UL and cUL listed for tub/shower enclosure when GFCI protected
- Motor equipped with thermal cutoff fuse
- Removable permanently lubricated plug-in motor

Housing:

- Environmentally friendly 26 gauge housing using Zinc-Aluminum-Magnesium (ZAM) coating
- Built-in damper reduces back draft and helps with blower door testing
- Built-in metal flange provides blocking for penetrations through drywall as an Air Barrier, and assists with the decrease in leakage in the Building Envelope during blower door testing
- Suitable for installation in ceilings insulated up to R60
- Articulating and expandable installation bracket up to 24"

Grille:

- Elegant grille design complements the aesthetics of any room
- Attaches directly to housing with torsion springs
- Includes a motion sensor cap for use as a cover when motion sensor Plug 'n Play[®] module has not been selected

Warranty:

- ECM Motor: 6 Years from original purchase date
- ALL Parts: 3 Years from original purchase date

Architectural Specifications:

Customizable ceiling mount ventilation fan, ENERGY STAR[®] rated with built-in 110/80/50 CFM speed selector. Fan can be upgraded with multi-speed module FV-VS15VK1 for expanded HVI-Certified performance 30-40-50-60-70-80-90-100-110 cfm for continuous ventilation. Home Ventilating Institute (HVI) Certified at 0.1, 0.25, 0.375, and 0.5" w.g. 6" Duct as Certified by the Home Ventilating Institute (HVI) – **ENERGY STAR MOST EFFICIENT 2024**

@ **0.1 w.g.**, 110/80/50 CFM with <0.3 sone and with energy efficiency no more than 16.7/18.4/14.7 CFM/Watt

@ **0.25 w.g.**, 110/80/50 CFM with no more than 0.3/0.3/0.4 sones and with energy efficiency no more than 9.3/8.8/7.2 CFM/Watt

@ **0.375 w.g.**, 110/80/50 CFM with energy efficiency no more than 6.6/6.1/5.3 CFM/Watt

@ **0.5" w.g.**, 109/80/50 CFM with energy efficiency no more than 4.8/4.6/4.0 CFM/Watt Utilizing 4" Duct with 6" to 4" reducer as Certified by the Home Ventilating Institute (HVI) – **ENERGY STAR MOST EFFICIENT 2024**

@ **0.1 w.g.**, 110/80/50 CFM with <0.3 sone and with energy efficiency no more than 11.5/14.2/13.5 CFM/Watt

@ **0.25 w.g.**, 110/80/50 CFM with no more than 0.8/0.7/0.6 sones and with energy efficiency no more than 7.3/7.7/7.0 CFM/Watt

@ **0.375 w.g.**, 110/80/50 CFM with energy efficiency no more than 5.3/5.4/5.0 CFM/Watt

@ **0.5" w.g.**, 104/80/50 CFM with energy efficiency no more than 4.2/4.1/3.8 CFM/Watt

The motor shall be enclosed with brushless ECM motor engineered to run continuously. ECM motor speed shall automatically increase when the fan senses static pressure to maintain selected CFM. Power rating shall be 120v/60Hz. Plug 'N Play[®] modules provide additional features such as Multi-Speed 30-110 CFM with Time Delay, Condensation Sensor, SmartAction Motion Sensor, Dual Motion Sensor + Condensation Sensor and Wi-Fi Module. Fan shall be RoHS Compliant and UL and cUL listed for tub/shower enclosure when GFCI protected. Also suitable for installation in ceilings insulated up to R60. Fan can be used to comply with NGBS, ASHRAE 62.2, LEED, ENERGY STAR[®] IAP, EarthCraft, and California Title-24.



ECM Motor Technology:

When fan senses static pressure, its speed is automatically increased to ensure that the desired CFM is not compromised, which allows the fan to perform as rated.

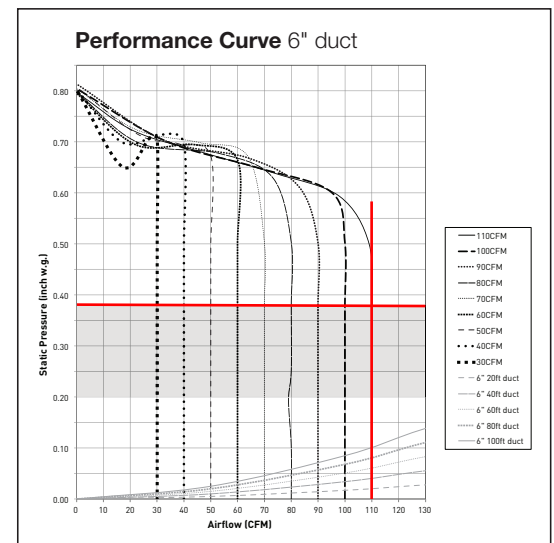
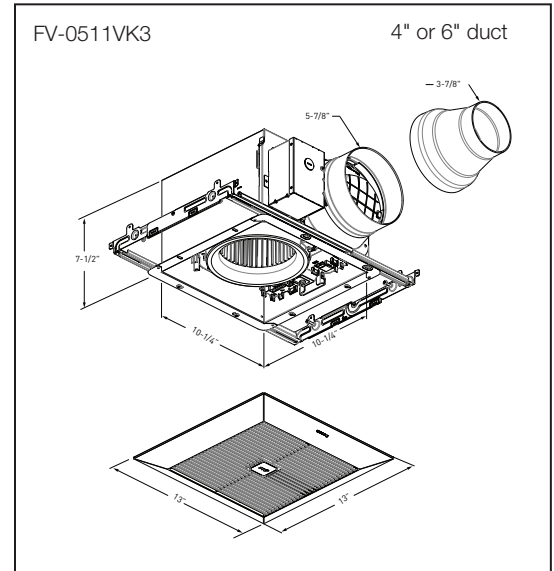

*Industry research indicates static pressure in typical installations ranges from 0.20" to 0.375"

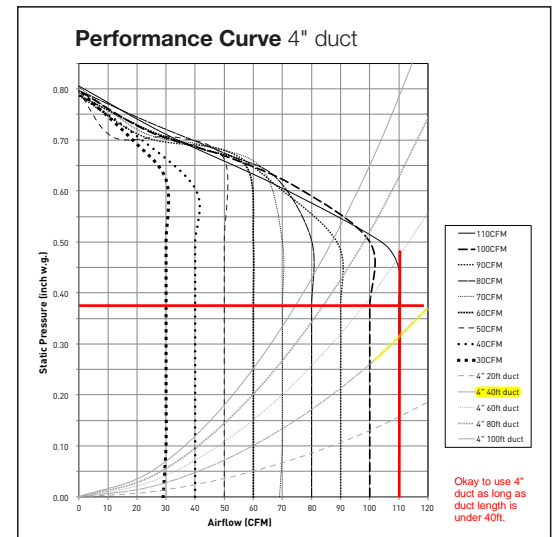

Okay to use 4" duct as long as duct length is under 40ft.

*Industry research indicates static pressure in typical installations ranges from 0.20" to 0.375"

Plug 'N Play™ Modules

Plug 'N Play™ modules provide up to three additional features. Select from Multi-Speed with Time Delay, Motion Sensor, and Condensation Sensor.



FV-VS15VK1: Multi-Speed with Time Delay

Allows you to select the proper CFM settings to satisfy ASHRAE 62.2 continuous ventilation requirements. The fan runs continuously at a pre-set lower level (0, 30-100 CFM, in 10 CFM increments), then elevates to a maximum level of operation (50-80-110 CFM) when the wall switch is turned on, or when the motion sensor or Condensation Sensor module is activated. A High/Low delay timer returns the fan to the pre-set CFM level after a period of time set by the user.



FV-MSVK1: Motion Sensor

Automatically activates when someone enters the room. Once the settings have been applied, the fan becomes truly automatic. This module also activates a 20 minute delay off timer for the fan.



FV-CSVK1: Condensation Sensor

Helps control bathroom condensation to prevent mold and mildew. Sensor technology detects relative humidity and temperature to anticipate dew point, automatically turning the fan on to control humidity. Built-in Relative Humidity (RH) sensitivity adjustment enables fine tuning for moist conditions and for satisfying CalGreen requirements. When the condensation sensor is used in conjunction with multi-speed functionality, the fan will kick up to high speed when the condensation sensor detects moisture in the room. This module also activates a 20 minute delay off timer for the fan.



FV-CMVK3: Smart Action® Motion Sensor + Condensation Sensor

Turns the base fan on or boosts to higher speed when condensation or motion are detected. Installer / User can choose the desired operation, thanks to advanced automation. Only one slot is required.



WP100PBA: Smart WiFi® Module

The Wi-Fi control module connects, monitors and controls through Wi-Fi the ventilation fan's features (motion sensor, light, etc.) with the Swidget app.

WhisperGreen® Select (Fan Only): FV-0511VK3																																				
Duct Diameter (inches)	6"																																			
Static Pressure in inches w.g.	0.1	0.25	0.375	0.5	0.1	0.25	0.375	0.5	0.1	0.25	0.375	0.5	0.1	0.25	0.375	0.5	0.1	0.25	0.375	0.5	0.1	0.25	0.375	0.5	0.1	0.25	0.375	0.5								
Air Volume (CFM)	110	110	110	109	100	100	100	100	90	90	90	80	80	80	80	70	70	70	70	60	60	60	60	50	50	50	50	40	40	40	40	30	30	30	30	
Noise (sones)	<0.3	0.3	---	---	<0.3	0.3	---	---	<0.3	0.3	---	---	<0.3	0.3	---	---	<0.3	0.3	---	---	<0.3	0.3	---	---	<0.3	0.4	---	---	<0.3	<0.3	---	---	<0.3	<0.3	---	---
Power Consumption (watts)	6.7	12.1	17.0	23.0	5.5	10.5	15.4	20.5	4.9	9.7	14.3	19.3	4.4	9.2	13.2	17.6	4.0	8.2	12.2	16.3	3.6	7.4	11.1	15.0	3.4	7.0	9.9	13.3	3.0	6.2	8.7	12.0	2.8	5.5	7.9	11.4
Energy Efficiency (CFM/Watt)	16.7	9.3	6.6	4.8	18.5	9.8	6.6	5.0	18.4	9.5	6.5	4.7	18.4	8.8	6.1	4.6	17.7	8.7	5.9	4.4	16.8	8.2	5.5	4.2	14.9	7.2	5.3	4.0	13.6	6.6	4.7	3.6	10.8	5.7	4.0	3.2
Speed (RPM)	595	887	1089	1261	580	892	1097	1260	572	898	1102	1283	569	908	1109	1281	565	902	1121	1283	570	906	1120	1293	575	933	1127	1296	563	921	1126	1294	587	930	1123	1300
Amps (Current)	0.11	0.20	0.27	0.36	0.10	0.18	0.25	0.32	0.09	0.17	0.24	0.31	0.08	0.16	0.22	0.28	0.08	0.14	0.20	0.27	0.07	0.13	0.19	0.24	0.07	0.12	0.17	0.22	0.06	0.11	0.15	0.20	0.06	0.10	0.14	0.19
MAX. Amps (Current)	0.36																																			
ENERGY STAR Qualified	Yes																																			

WhisperGreen® Select (Fan Only): FV-0511VK3																																				
Duct Diameter (inches)	4"																																			
Static Pressure in inches w.g.	0.1	0.25	0.375	0.5	0.1	0.25	0.375	0.5	0.1	0.25	0.375	0.5	0.1	0.25	0.375	0.5	0.1	0.25	0.375	0.5	0.1	0.25	0.375	0.5	0.1	0.25	0.375	0.5	0.1	0.25	0.375	0.5	0.1	0.25	0.375	0.5
Air Volume (CFM)	110	110	110	104	100	100	100	100	90	90	89	80	80	80	80	70	70	70	70	60	60	60	60	50	50	50	50	40	40	40	40	30	30	30	30	
Noise (sones)	<0.3	0.8	---	---	<0.3	0.7	---	---	<0.3	0.7	---	---	<0.3	0.7	---	---	<0.3	0.7	---	---	<0.3	0.7	---	---	<0.3	0.6	---	---	<0.3	0.6	---	---	<0.3	0.6	---	---
Power Consumption (watts)	9.7	15.2	21.0	24.7	7.8	13.0	18.0	23.5	6.6	11.6	16.2	21.0	5.6	10.6	14.7	19.4	5.1	9.3	13.4	17.0	4.4	8.1	11.7	15.5	3.8	7.3	10.4	13.6	3.4	6.3	9.3	12.0	2.9	5.6	8.4	11.5
Energy Efficiency (CFM/Watt)	11.5	7.3	5.3	4.2	12.9	7.8	5.6	4.3	13.6	7.7	5.6	4.2	14.2	7.7	5.4	4.1	14.0	7.6	5.3	4.2	13.8	7.6	5.2	3.9	13.5	7.0	5.0	3.8	12.9	6.9	4.6	3.6	10.5	5.7	3.8	3.0
Speed (RPM)	782	1031	1214	1349	747	1007	1189	1349	714	993	1170	1333	684	985	1166	1340	672	964	1164	1317	654	956	1148	1324	630	946	1145	1313	619	938	1142	1299	606	939	1141	1304
Amps (Current)	0.16	0.24	0.33	0.38	0.14	0.22	0.29	0.37	0.12	0.20	0.26	0.33	0.10	0.18	0.24	0.31	0.09	0.16	0.22	0.27	0.08	0.14	0.19	0.25	0.07	0.13	0.17	0.22	0.66	0.11	0.16	0.20	0.58	0.10	0.14	0.19
MAX. Amps (Current)	0.66																																			
ENERGY STAR Qualified	Yes																																			

Model	Quantity	Comments	Project:
			Location:
			Architect:
			Engineer:
			Contractor:
			Submitted by:
			Date:

For complete Installation Instructions visit na.panasonic.com/us/iaq

Panasonic
IAQ Division
Two Riverfront Plaza
Newark, NJ 07102

na.panasonic.com/us/iaq



Design and specifications subject to change without notice.



930I SERIES

23-05 - Equipment HVAC- Heater

EUH-1

ARCHITECT'S AND ENGINEER'S SPECIFICATIONS*

The heating equipment shall include an electric automatic fan forced air heater suitable for small area heating, as manufactured by Indeeco®. The heater shall be designed for wall mounting, recess or surface. Heaters shall be cETLus listed.

BACK BOX: The back box shall be designed as a recessed rough-in box in either masonry or frame installations and is also used when surface mounting frames are used in surface mounting installations. The back box shall be heavy gauge galvanized steel and shall contain knockouts through which power leads enter.

INNER FRAME ASSEMBLY: The heater assembly, which fits into the back box, shall consist of a heavy gauge steel fan panel to which all of the operational parts of the heater are mounted. The inner frame assembly shall be completely prewired.

HEATING ELEMENT: The heating element shall be of the non-glowing design consisting of an 80/20 nickel-chromium resistance wire enclosed in a steel sheath to which plate fins are copper brazed. The element shall cover the entire air discharge area to ensure uniform heating of all

discharged air. It shall be warranted for 5 years.

MOTOR AND CONTROLS: The fan motor shall be a shaded 2 pole, impedance protected, class B"insulation with permanently lubricated. The thermostat shall be singlepole type on all models. Thermal cutout shall be to self-hold (manual-reset), snap-action type designed to shut off heat in the event of overheating. The fan shall be tangential blower for whisper quiet operation.

SURFACE MOUNTING FRAME: The surface mounting frame shall be of heavy gauge steel designed to mount around the back box for a finished surface installation. Slot knock outs shall be provided for power supply conduit.

FRONT COVER: The louvered front cover shall be of heavy gauge steel with a powder paint finish. A plug button will be provided to replace the thermostat knob and render the unit tamper-resistant. **FINISH:** All sheet metal parts, except the galvanized steel back box, shall be phosphatized, then completely painted by a powder paint process.

**Indeeco reserves the right to change specifications without prior notice.*

Models & Specifications:

CATALOG NO.	ELECTRICAL DATA					
	VOLTS	WATTS	AMPS	BTU/HR.	BUILT-IN THERMOSTAT	SHIP WT.
930IW-R1500T2-W	120	1500/1125/750/375	12.5/9.4/6.3/3.1	5120-1280	Double Pole	11 lbs
930IW-R2004T2-W	240*	2000/1500/1000/500	8.3/6.3/4.2/2.1	6826-1706	Double Pole	11 lbs
930IW-R2404T2-W	240*	2400/1800/1200/600	10.0/7.5/5.0/2.5	8192-2048	Double Pole	11 lbs

NOTE: For wall mounting only. Do not install back box closer than 4 in. from floor, 6 in. from adjacent walls and 36 in. from the ceiling. Do not install heater behind towel rack, behind door, in floor, in closet, in ceiling or where airflow may be obstructed. To insure proper operation, maintain 5 ft. minimum clearance to furniture or other objects placed directly in front of the heater.

*Will operate on 208V at 75% of rated wattages. For installations over 7,500 ft. above sea level we recommend using models under 1500 watts. "T2-W" Model are complete heater assemblies with grille, back box, and thermostat.

Optional Accessories:

CATALOG NO.	DESCRIPTION	SHIP WT.
WIX-RBB-W	Single Backbox For GFR Series Heater	2 lbs
WIX-RBB6-W	Multi-Pack Backbox (6Pcs)	10 lbs
WIT-RTSP-Z	Single-Pole Thermostat (Field-Installed)	1 lbs
WIT-RTDP-Z	Double-Pole Thermostat (Field-Installed)	1 lbs
WIF-RSM-W	Surface Mounting Frame	2 lbs

Dimensions and Clearances:

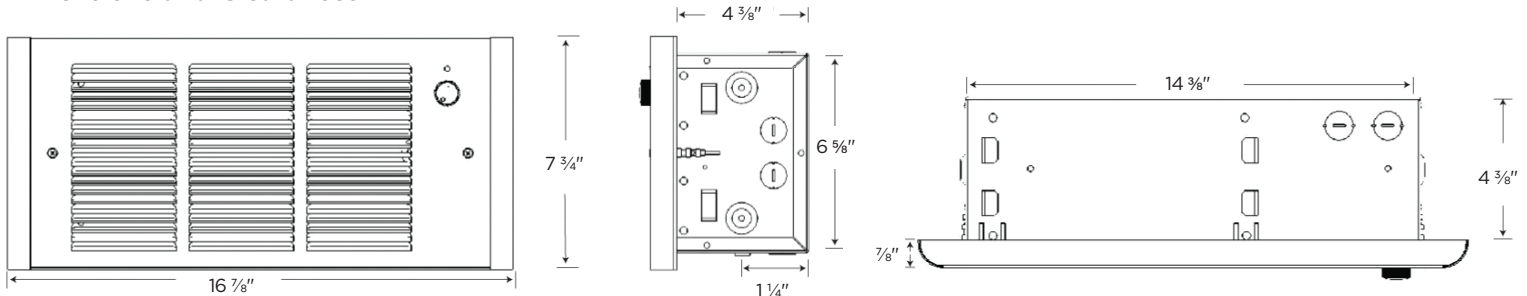

No matter the industry or application, Indeeco has a robust portfolio of innovative, reliable, high-performance comfort heating and ventilation solutions for all your heating needs.

941I SERIES

23-06 - Equipment HVAC- Heater

EUH-2

ARCHITECT'S AND ENGINEER'S SPECIFICATIONS*

The heating equipment shall include an electric automatic 941I Series fan-forced air heater suitable for small area heating as manufactured by Indeeco®. Heaters shall be cETLus Listed. The heater shall be designed for surface or recessed ceiling mounting. For surface mounting, an Indeeco FIF-ASM surface mounting frame shall be used.

BACK BOX: The back box shall be designed for duty as a recessed rough-in box in either masonry or frame construction, and also when mounting directly to the surface of the finished ceiling in surface mounting installations. The back box shall be 20-gauge galvanized steel and shall contain knockouts through which field wiring leads are brought.

INNER FRAME ASSEMBLY: The inner frame assembly shall consist of a 20-gauge steel chassis on which are mounted the heating element, fan motor and blade, fan control and thermal cutout. The inner frame assembly shall be completely pre-wired.

HEATING ELEMENT: The heating element shall be warrantied for five years and shall be of non-glowing design consisting of a special resistance wire, enclosed in a steel sheath to which steel plate fins are brazed. The element shall cover the entire air discharge area to ensure uniform heating of all discharge air.

MOTOR AND CONTROLS: The fan motor shall be impedance protected, permanently lubricated and with totally enclosed rotor. Fan control shall be bi-metallic, snap-action type and shall activate fan after heating element reaches operating temperature, and continue to operate the fan after the thermostat is satisfied and until all heated air has been discharged. Thermal cutout shall be bi-metallic, snap-action type designed to shut off heater in the event of overheating and reactivate the heater when temperatures return to normal.

DISCONNECT SWITCH: A factory installed double-pole single throw disconnect switch shall be provided for positive disconnect of power supply. It will be completely concealed behind the front cover.

FRONT COVER: The louvered front cover shall be of commercial grade steel finished in White baked enamel. It will attach to the fan deck via snaps in the plastic trim pieces and shall have no exposed screw heads.

FINISH: All sheet metal parts, except the front cover and galvanized back box, shall be phosphatized, then completely painted by a baked enamel painting process.

**Indeeco reserves the right to change specifications without prior notice.*

Models & Specifications:

ITEM INFORMATION	ELECTRICAL DATA			SHIP WT.
	CATALOG NO.	VOLTS	WATTS	
941IF-U1000-W	120	1000	8.3	10 lbs
		500	4.7	10 lbs
941IF-U1500-W	120	1500	12.5	10 lbs
		750	6.3	10 lbs
941IF-U2004-W	240/208	2000/1500	8.3/7.2	10 lbs
		1000/750	4.2/3.6	10 lbs
941IF-U2007-W	277/240	2000/1500	7.2/6.3	10 lbs
		1000/750	3.6/3.1	10 lbs

NOTE: Factory-wired for highest wattage, field-convertible to lower wattages.

Optional Accessories:

CATALOG NO.	DESCRIPTION	SHIP WT.
FIF-ASM-W	Surface mounting sleeve, White	2 lbs
FIF-AS1-W	1 in. Semi-Recessed Frame, White	
FIF-AS2-W	2 in. Semi-Recessed Frame, White	
FIF-HTBF-W	T-Bar Frame Kit, White	5 lbs

NOTE: Requires two separate leads from heater to single-pole wall thermostat.

Mounting Limitations:

Heaters are designed for surface or recessed mounting in ceiling. They must be mounted a minimum of 6' from floor and 24" from any adjacent wall or obstruction.

NOTE: In order to have the fan delay operate correctly, three wires are required between the heater and the wall thermostat. (See figure 1).

Wiring Diagram:

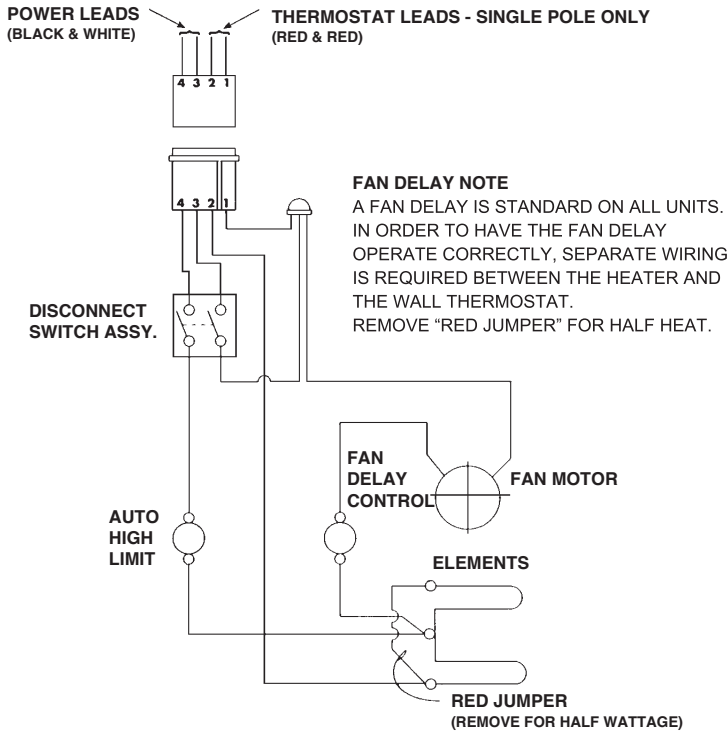

Dimensions and Clearances:

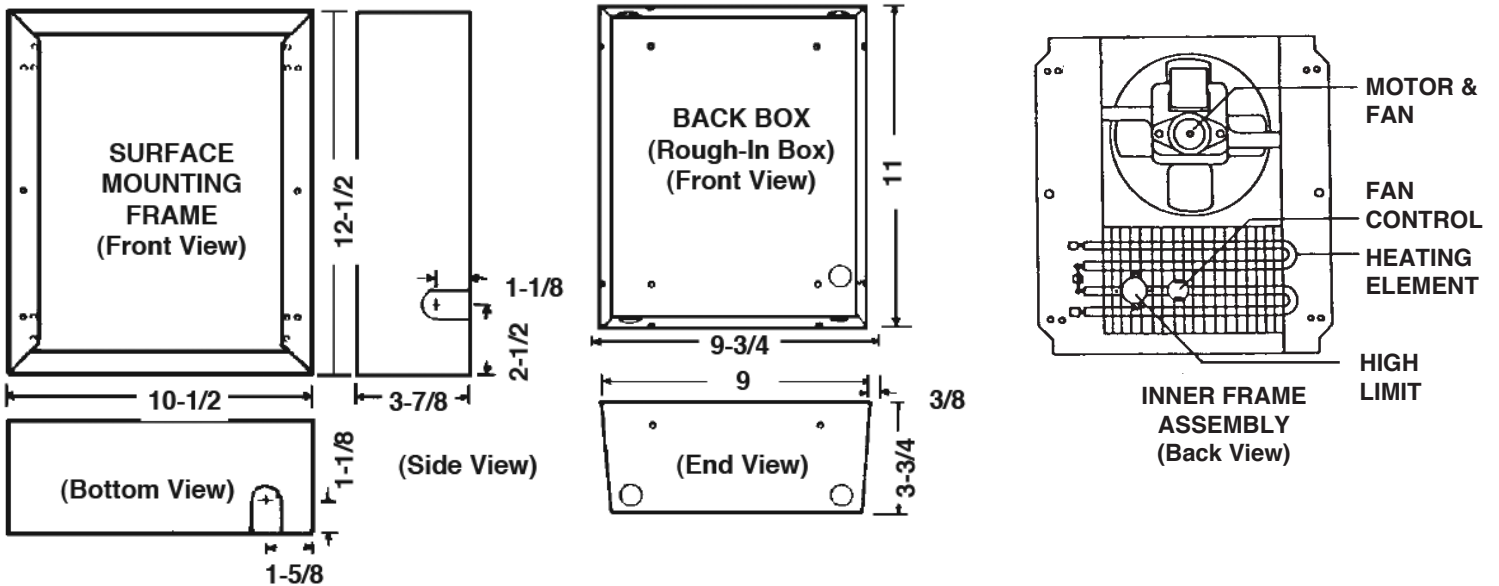

No matter the industry or application, Indeeco has a robust portfolio of innovative, reliable, high-performance comfort heating and ventilation solutions for all your heating needs.